

Jainson COPPER TUBULAR CRIMPING TERMINAL SOCKETS



ITEM NO.	AREA mm ²	E Dia	Jainson CAT. No.	DOWELL'S CAT. No.	PRICE EACH
1	2.5	5.2	319-05	CUS-05	4.98
2	4	6.5	319-06	CUS-06	7.03
3	6	6.5	319-07	CUS-07	7.65
4	10	6.5	319-08	CUS-08	9.66
5	16	6.5	319-09	CUS-09	12.88
6	25	6.5	319-10	CUS-10	21.90
7	35	6.5	319-11	CUS-11	24.40
8	35	8.2	319-12	CUS-12	24.40
9	50	6.5	319-13	CUS-13	31.20
10	50	8.2	319-14	CUS-14	31.20
11	50	10.2	319-15	CUS-15	31.20
12	70	8.2	319-16	CUS-16	50.80
13	70	10.2	319-17	CUS-17	50.80
14	70	12.7	319-18	CUS-18	50.80
15	95	10.2	319-19	CUS-19	70.65
16	95	12.7	319-20	CUS-20	70.65
17	120	10.2	319-21	CUS-21	98.00
18	120	12.7	319-22	CUS-22	98.00
19	120	16.2	319-23	CUS-23	98.00
20	150	10.2	319-24	CUS-24	122.15
21	150	12.7	319-25	CUS-25	122.15
22	150	16.2	319-26	CUS-26	122.15
23	185	12.7	319-27	CUS-27	188.63
24	185	16.2	319-28	CUS-28	188.63
25	225	16.2	319-231	CUS-231	251.85
26	240	16.2	319-29	CUS-29	253.76
27	240	20.3	319-30	CUS-30	253.76
28	300	16.2	319-31	CUS-31	366.65
29	300	20.3	319-32	CUS-32	366.65
30	400	20.3	319-33	CUS-33	531.79
31	500	20.3	319-34	CUS-34	738.41
32	630	20.3	319-35	CUS-35	1021.44
33	800	319-062	CUS-062	1617.28
34	1000	319-076	CUS-076	2968.56

Jainson COPPER TUBULAR CRIMPING TERMINAL SOCKETS



(HEAVY DUTY)

ITEM NO.	AREA mm ²	E Dia	Jainson CAT. No.	DOWELL'S CAT. No.	PRICE EACH
35	25	8.2	319-282	CUS-282	32.23
36	35	8.2	319-283	CUS-283	50.34
37	50	8.2	319-284	CUS-284	81.13
38	70	10.2	319-285	CUS-285	127.71
39	95	12.7	319-286	CUS-286	190.95
40	120	12.7	319-287	CUS-287	267.39
41	150	12.7	319-288	CUS-288	330.51
42	185	12.7	319-289	CUS-289	478.98
43	240	16.2	319-290	CUS-290	672.16
44	300	16.2	319-291	CUS-291	837.20
45	400	20.3	319-292	CUS-292	1223.78

Jainson SOLDERING TYPE COPPER TUBULAR SOCKETS



ITEM NO.	AREA Amp.	E Dia	Jainson CAT. No.	DOWELL'S CAT. No.	PRICE EACH
46	15	3.2	423-201	DEW-201	5.39
47	30	5.1	423-202	DEW-202	7.83
48	60	6.4	423-203	DEW-203	19.71
49	100	9.5	423-204	DEW-204	39.24
50	150	9.5	423-205	DEW-205	66.13
51	200	12.7	423-206	DEW-206	103.75
52	300	12.7	423-207	DEW-207	198.51
53	400	15.9	423-208	DEW-208	238.84
54	500	19.0	423-209	DEW-209	323.05
55	600	19.0	423-210	DEW-210	497.76
56	800	23.8	423-211	DEW-211	907.68
57	1000	23.8	423-212	DEW-212	1342.98
58	1000mm ²	423-295	DEW-295	2365.83

Jainson SOLDERING TYPE COPPER TUBULAR SOCKETS



(HEAVY DUTY)

ITEM NO.	AREA Amp.	E Dia	Jainson CAT. No.	DOWELL'S CAT. No.	PRICE EACH
59	15	5.1	219-6	BSS-6	9.50
60	30	7.1	219-7	BSS-7	17.01
61	60	10.3	219-8	BSS-8	33.03
62	100	11.9	219-9	BSS-9	56.74
63	150	13.5	219-10	BSS-10	102.50
64	200	13.5	219-11	BSS-11	174.61
65	300	16.7	219-12	BSS-12	242.50
66	400	16.7	219-13	BSS-13	383.81
67	500	19.8	219-14	BSS-14	615.01

AS PER TABLE 2~OF BS -91-1973

Sq.mm					
68	6	5.5	219-15	BSS-15	10.50
69	16	6.6	219-16	BSS-16	21.01
70	25	9.0	219-17	BSS-17	35.99
71	35	9.0	219-18	BSS-18	48.40
72	70	11	219-23	BSS-23	141.81
73	95	14	219-24	BSS-24	199.81
74	120	14	219-25	BSS-25	341.01
75	185	14	219-26	BSS-26	568.80
76	240	18	219-27	BSS-27	687.20
77	300	18	219-28	BSS-28	953.01
78	500	22	219-29	BSS-29	1395.81
79	625	26	219-30	BSS-30	1941.90

Jainson COPPER TUBULAR CRIMPING INLINE CONNECTORS



ITEM NO.	AREA mm ²	Jainson CAT. No.	DOWELL'S CAT. No.	PRICE EACH
80	1.5	58-450	EH-450	3.55
81	1.5	58-453	EH-453	3.65
82	2.5	58-451	EH-451	3.88
83	2.5	58-454	EH-454	3.96
84	4-6	58-452	EH-452	5.48
85	4-6	58-455	EH-455	5.75
86	10	58-456	EH-456	8.01
87	10	58-460	EH-460	9.56
88	16	58-461	EH-461	19.59
89	25	58-484	EH-484	26.21
90	25	58-486	EH-486	57.01
91	35	58-485	EH-485	34.21
92	35	58-487	EH-487	70.00
93	50	58-480	EH-480	104.00
94	70	58-478	EH-478	77.01
95	70	58-481	EH-481	154.00
96	95	58-482	EH-482	218.00
97	1.5	58-463 (I)	EH-463 (I)	5.15
98	2.5	58-464 (I)	EH-464 (I)	6.15
99	4-6	58-465 (I)	EH-465 (I)	9.21
100	2.5	58-466	EH-466	3.76
101	4-6	58-475 (I)	EH-475 (I)	13.76
102	2.5	32-23	CB-23	4.16
103	4	32-3	CB-3	5.54
104	6	32-4	CB-4	5.75
105	16	32-6	CB-6	9.20
106	25	32-7	CB-7	22.13
107	35	32-8	CB-8	28.61
108	50	32-9	CB-9	44.06
109	70	32-10	CB-10	66.80
110	95	32-11	CB-11	90.30
111	120	32-12	CB-12	125.81
112	150	32-13	CB-13	162.00
113	185	32-14	CB-14	203.01
114	225	32-20	CB-20	279.01
115	240	32-15	CB-15	293.81
116	300	32-16	CB-16	439.20
117	400	32-17	CB-17	668.40
118	500	32-18	CB-18	874.13
119	625	32-19	CB-19	1193.81
120	800	32-21	CB-21	1858.00
121	1000	32-22	CB-22	2700.00
122	25	32-24	CB-24	21.03
123	35	32-25	CB-25	28.70
124	50	32-26	CB-26	43.53
125	70	32-27	CB-27	77.81
126	95	32-28	CB-28	114.40
127	120	32-29	CB-29	137.38
128	150	32-30	CB-30	197.90
129	300	32-33	CB-33	587.01
130	1.5	32-41	CB-41	4.46
131	800	32-42	CB-42	2256.00
132	1000	32-43	CB-43	3361.93
133	20	32-47	CB-47	11.81
134	70	32-51	CB-51	69.90
135	95	32-52	CB-52	103.84
136	120	32-53	CB-53	124.21
137	150	32-54	CB-54	176.00
138	185	32-55	CB-55	237.81
139	240	32-56	CB-56	363.90
140	300	32-57	CB-57	501.01
141	400	32-58	CB-58	676.00
142	500	32-59	CB-59	972.00
143	550	32-60	CB-60	1056.00
144	630	32-61	CB-61	1334.00
145	185	32-31	CB-31	271.81
146	240	32-32	CB-32	415.20
147	400	32-34	CB-34	810.90
148	500	32-35	CB-35	1191.50

CABLE TERMINAL ENDS

Jainson COPPER TUBULAR CRIMPING TERMINAL SOCKETS



(ICF)

ITEM NO.	AREA mm ²	Jainson CAT. No.	DOWELL'S CAT. No.	PRICE EACH
149	11-17	319-106	CUS-106	29.94
150	11-23	319-107	CUS-107	50.34
151	11-23	319-108	CUS-108	55.34
152	11-17	319-109	CUS-109	31.49
153	23-29	319-110	CUS-110	73.54
154	23-29	319-111	CUS-111	69.60
155	45-57	319-112	CUS-112	164.53
156	29-45	319-113	CUS-113	98.34
157	57-75	319-114	CUS-114	209.04
158	90-110	319-115	CUS-115	280.80
159	29-45	319-116	CUS-116	98.34
160	146-183	319-128	CUS-128	561.60
161	75-90	319-137	CUS-137	229.21
162	110-146	319-138	CUS-138	411.43
163	183-225	319-139	CUS-139	641.05
164	225-299	319-140	CUS-140	905.84
165	299-366	319-141	CUS-141	1220.75
166	366-437	319-142	CUS-142	1670.24
167	11-17	319-145	CUS-145	29.94
168	11-17	319-146	CUS-146	29.94
169	17-23	319-147	CUS-147	50.34
170	17-23	319-148	CUS-148	50.34
171	23-29	319-149	CUS-149	72.50
172	23-29	319-150	CUS-150	72.50
173	23-29	319-151	CUS-151	72.50
174	29-45	319-152	CUS-152	98.29
175	29-45	319-153	CUS-153	98.29
176	29-45	319-154	CUS-154	98.29
177	45-57	319-155	CUS-155	164.53
178	45-57	319-156	CUS-156	164.53
179	45-57	319-157	CUS-157	164.53
180	57-75	319-158	CUS-158	207.38
181	57-75	319-159	CUS-159	207.38
182	57-75	319-160	CUS-160	207.38
183	75-90	319-161	CUS-161	229.43
184	75-90	319-162	CUS-162	229.43
185	75-90	319-163	CUS-163	229.43
186	90-110	319-164	CUS-164	280.80
187	90-110	319-165	CUS-165	280.80
188	90-110	319-166	CUS-166	280.80
189	110-146	319-167	CUS-167	411.84
190	110-146	319-168	CUS-168	411.84
191	110-146	319-169	CUS-169	411.84
192	146-183	319-170	CUS-170	561.60
193	146-183	319-171	CUS-171	561.60
194	183-225	319-172	CUS-172	641.05
195	183-225	319-173	CUS-173	641.05
196	183-225	319-174	CUS-174	641.05
197	225-299	319-175	CUS-175	927.68
198	225-299	319-176	CUS-176	915.20
199	299-366	319-177	CUS-177	1289.60
200	299-366	319-178	CUS-178	1289.60
201	366-437	319-179	CUS-179	1770.08
202	366-437	319-180	CUS-180	1770.08

Jainson COPPER TUBULAR CRIMPING TERMINAL SOCKETS



(DLW)

ITEM NO.	AREA mm ²	Jainson CAT. No.	DOWELL'S CAT. No.	PRICE EACH
203	133	319-36	CUS-36	353.19
204	133	319-37	CUS-37	353.19
205	133	319-38	CUS-38	281.84
206	133	319-39	CUS-39	288.08
207	133	319-40	CUS-40	353.19
208	133	319-41	CUS-41	302.01
209	270	319-42	CUS-42	672.05
210	270	319-43	CUS-43	699.93
211	270	319-44	CUS-44	728.00
212	400	319-45	CUS-45	1069.75
213	400	319-46	CUS-46	1069.75
214	133	319-47	CUS-47	328.64
215	270	319-48	CUS-48	741.31
216	270	319-49	CUS-49	771.89
217	400	319-50	CUS-50	1308.74
218	133	319-51	CUS-51	470.08

Jainson COPPER TUBULAR CRIMPING TERMINAL SOCKETS



(CLW)

ITEM NO.	AREA mm ²	Jainson CAT. No.	DOWELL'S CAT. No.	PRICE EACH
219	150	319-54	CUS-54	473.20
220	120	319-55	CUS-55	365.04
221	25	319-56	CUS-56	39.53
222	3	319-65	CUS-65	9.10
223	3	319-66	CUS-66	9.10
224	3	319-67	CUS-67	9.10
225	10	319-68	CUS-68	31.83
226	10	319-69	CUS-69	31.83
227	120	319-70	CUS-70	361.71
228	225	319-71	CUS-71	608.19
229	270	319-72	CUS-72	994.45
230	475	319-73	CUS-73	1680.64
231	475	319-74	CUS-74	1941.68
232	475	319-75	CUS-75	1676.48
233	50	319-87	CUS-87	101.93
234	35	319-187	CUS-187	68.59
235	3	319-209	CUS-209	8.80
236	3	319-210	CUS-210	8.80
237	3	319-211	CUS-211	22.68
238	25	319-212	CUS-212	41.30
239	225	319-213	CUS-213	603.20
240	225	319-214	CUS-214	724.05
241	270	319-215	CUS-215	872.56
242	10	319-228	CUS-228	29.94
243	70	319-229	CUS-229	150.51
244	50	319-230	CUS-230	103.90

Jainson COPPER TUBULAR CRIMPING END SEALING FERRULES



ITEM NO.	AREA mm ²	Jainson CAT. No.	DOWELL'S CAT. No.	PRICE EACH
245	0.5	58-508	EH-508	0.75
246	0.75	58-509	EH-509	0.75
247	1.0	58-510	EH-510	0.75
248	1.0	58-511	EH-511	1.03
249	1.5	58-512	EH-512	1.03
250	1.5	58-513	EH-513	1.24
251	2.5	58-514	EH-514	1.03
252	2.5	58-515	EH-515	1.19
253	4	58-516	EH-516	1.03
254	4	58-517	EH-517	1.19
255	6	58-518	EH-518	1.19
256	6	58-519	EH-519	1.19
257	6	58-520	EH-520	1.35
258	10	58-521	EH-521	1.35
259	10	58-522	EH-522	1.48
260	10	58-523	EH-523	1.75
261	16	58-524	EH-524	1.56
262	16	58-525	EH-525	1.84
263	16	58-526	EH-526	2.11

Jainson COPPER CRIMPING INLINE CONNECTORS



(HEAVY DUTY)

ITEM NO.	AREA mm ²	Jainson CAT. No.	Length J	PRICE EACH
264	1.5	JC-1.5	22.2	4.64
265	2.5	JC-2.5	22.2	5.96
266	4	JC-4	22.2	7.60
267	6	JC-6	22.2	8.36
268	10	JC-10	22.2	13.36
269	16	JC-16	44.4	20.80
270	20	JC-20	44.5	29.50
271	25	JC-25	47.6	31.41
272	35	JC-35	47.6	37.04
273	50	JC-50	47.6	53.90
274	70	JC-70	50.8	77.78
275	95	JC-95	54	99.81
276	120	JC-120	65	163.10
277	150	JC-150	65	188.91
278	185	JC-185	65	259.81
279	240	JC-240	89	389.41
280	300	JC-300	89	587.41
281	400	JC-400	89	789.10
282	500	JC-500	115	1114.21
283	550	JC-550	115	1185.01
284	630	JC-630	115	1259.01
285	800	JC-800	230	2118.00
286	1000	JC-1000	230	3010.00

Jainson COPPER TUBULAR TERMINAL ENDS



(DOUBLE HOLE)

ITEM NO.	AREA mm ²	Jainson CAT. No.	PRICE EACH
287	42	319-81	234.41
288	100	319-82	411.89
289	133	319-83	446.36

CABLE TERMINAL ENDS

Jainson COPPER TUBULAR CRIMPING TERMINAL ENDS HEAVY DUTY (XLPE)



ITEM NO.	AREA mm ²	E DIA	Jainson CAT. No.	PRICE EACH
290	1.5	5.2	319-538	7.83
291	1.5	6.5	319-539	7.83
292	2.5	4.2	319-388	8.44
293	2.5	5.2	319-540	8.44
294	2.5	6.5	319-541	8.44
295	4	5.2	319-389	9.60
296	4	6.5	319-543	9.60
297	6	5.2	319-390	12.34
298	6	6.5	319-544	12.34
299	6	8.4	319-545	12.34
300	10	6.5	319-353	14.40
301	10	8.4	319-547	14.40
302	16	6.5	319-354	18.35
303	16	8.4	319-549	18.35
304	25	6.5	319-355	28.05
305	25	8.4	319-551	28.05
306	25	10.5	319-552	28.05
307	35	6.5	319-542	37.65
308	35	8.4	319-356	37.65
309	35	10.5	319-554	37.65
310	50	8.4	319-357	59.16
311	50	10.5	319-556	59.16
312	70	8.4	319-557	91.90
313	70	10.5	319-358	91.90
314	70	13	319-559	91.90
315	95	10.5	319-359	141.30
316	95	13	319-560	141.30
317	120	13	319-241	180.45
318	120	17	319-546	180.45
319	150	13	319-242	228.34
320	150	17	319-564	228.34
321	185	17	319-243	307.96
322	240	17	319-244	453.26
323	240	21	319-567	453.26
324	300	17	319-245	649.04
325	300	21	319-569	649.04
326	400	17	319-246	1044.41
327	400	21	319-571	1044.41
328	500	21	319-247	1321.49
329	550	21	319-573	1617.28
330	630	21	319-248	1870.51
331	800	319-599	2987.71
332	1000	319-590	4428.36

Jainson COPPER TUBULAR CRIMPING INLINE CONNECTORS



ITEM NO.	AREA mm ²	Jainson CAT. No.	DOWELL'S CAT. No.	PRICE EACH
333	1.5	58-459	EH-459	3.65
334	4	58-495	EH-495	3.16
335	6	58-568	EH-568	4.93
336	10	58-569	EH-569	5.94
337	16	58-570	EH-570	7.45
338	25	58-571	EH-571	9.38
339	35	58-500	EH-500	10.10
340	50	58-572	EH-572	14.05
341	70	58-497	EH-497	14.69
342	95	58-573	EH-573	18.85
343	120	58-574	EH-574	23.33
344	150	58-575	EH-575	25.45
345	185	58-496	EH-496	57.89
346	240	58-578	EH-578	202.18
347	16	58-457	EH-457	10.75
348	50	58-477	EH-477	52.41
349	95	58-479	EH-479	100.61
350	0.5	58-651	EH-651	3.76

Jainson ALUMINIUM TUBULAR TERMINAL SOCKETS



ITEM NO.	AREA mm ²	E DIA	Jainson CAT. No.	DOWELL'S CAT. No.	PRICE EACH
351	2.5	3.2	119-151	ALS-151	1.75
352	2.5	3.7	119-309	ALS-309	1.75
353	4	4.2	119-155	ALS-155	1.75
354	4	5.1	119-317	ALS-317	1.90
355	6	5.2	119-158	ALS-158	1.90
356	6	6.5	119-313	ALS-313	1.90
357	10	4.2	119-159	ALS-159	2.40
358	10	6.4	119-214	ALS-214	2.60
359	10	8.2	119-215	ALS-215	2.60
360	16	6.4	119-252	ALS-252	3.10
361	16	8.2	119-216	ALS-216	3.10
362	16	10.2	119-217	ALS-217	3.10
363	25	6.4	119-253	ALS-253	3.90
364	25	8.2	119-218	ALS-218	3.90
365	25	10.2	119-219	ALS-219	3.95
366	25	12.7	119-220	ALS-220	3.95
367	35	6.4	119-254	ALS-254	5.15
368	35	8.2	119-221	ALS-221	5.15
369	35	10.2	119-222	ALS-222	5.15
370	50	8.2	119-255	ALS-255	7.65
371	50	10.2	119-312	ALS-312	7.65
372	50	12.7	119-224	ALS-224	7.65
373	70	8.2	119-256	ALS-256	11.30
374	70	10.2	119-225	ALS-225	11.30
375	70	12.7	119-226	ALS-226	11.30
376	95	10.2	119-227	ALS-227	12.80
377	95	12.7	119-228	ALS-228	12.80
378	95	16.2	119-229	ALS-229	12.80
379	120	10.2	119-257	ALS-257	17.75
380	120	12.7	119-230	ALS-230	17.75
381	120	16.2	119-231	ALS-231	17.75
382	150	10.2	119-258	ALS-258	22.95
383	150	12.7	119-232	ALS-232	22.95
384	150	16.2	119-233	ALS-233	23.00
385	185	10.2	119-311	ALS-311	28.85
386	185	12.7	119-234	ALS-234	28.85
387	185	16.2	119-235	ALS-235	28.85
388	225	12.7	119-320	ALS-320	40.70
389	240	12.7	119-236	ALS-236	49.35
390	240	16.2	119-237	ALS-237	49.35
391	300	16.2	119-300	ALS-300	69.10
392	300	20.3	119-259	ALS-259	69.10
393	400	20.3	119-260	ALS-260	99.75
394	500	20.3	119-296	ALS-296	143.75
395	630	20.3	119-261	ALS-261	188.35
396	800	119-318	ALS-318	284.60
397	1000	119-319	ALS-319	433.70

Jainson
S.J. METAL INDUSTRIES
An ISO 9001-2008 COMPANY

Jainson ALUMINIUM TUBULAR LONG BARREL SOCKETS



ITEM NO.	AREA mm ²	E DIA	Jainson CAT. No.	DOWELL'S CAT. No.	PRICE EACH
398	2.5	3.2	119-551	ALS-551	2.20
399	2.5	3.7	119-509	ALS-509	2.20
400	4	4.2	119-555	ALS-555	2.20
401	4	5.1	119-517	ALS-517	2.45
402	6	5.2	119-558	ALS-558	2.45
403	6	6.5	119-513	ALS-513	2.45
404	10	4.2	119-514	ALS-514	3.10
405	10	6.4	119-515	ALS-515	3.10
406	16	6.4	119-552	ALS-552	3.95
407	16	8.2	119-516	ALS-516	3.80
408	16	10.2	119-617	ALS-617	3.80
409	25	8.2	119-518	ALS-518	4.60
410	25	10.2	119-519	ALS-519	4.55
411	25	12.7	119-520	ALS-520	4.55
412	35	8.2	119-521	ALS-521	6.40
413	35	10.2	119-522	ALS-522	6.40
414	50	8.2	119-655	ALS-655	9.60
415	50	10.2	119-512	ALS-512	9.60
416	50	12.7	119-524	ALS-524	9.60
417	70	8.2	119-556	ALS-556	14.70
418	70	10.2	119-525	ALS-525	14.70
419	70	12.7	119-526	ALS-526	14.70
420	95	10.2	119-527	ALS-527	16.15
421	95	12.7	119-528	ALS-528	16.15
422	95	16.2	119-529	ALS-529	16.15
423	120	10.2	119-557	ALS-557	22.50
424	120	12.7	119-530	ALS-530	22.50
425	120	16.2	119-531	ALS-531	22.50
426	150	10.2	119-658	ALS-658	29.30
427	150	12.7	119-532	ALS-532	29.30
428	150	16.2	119-533	ALS-533	29.30
429	185	10.2	119-511	ALS-511	35.65
430	185	12.7	119-534	ALS-534	35.65
431	185	16.2	119-535	ALS-535	35.65
432	225	12.7	119-620	ALS-620	49.95
433	240	12.7	119-536	ALS-536	62.30
434	240	16.2	119-537	ALS-537	62.30
435	300	16.2	119-500	ALS-500	86.80
436	300	20.3	119-559	ALS-559	86.80
437	400	20.3	119-560	ALS-560	126.80
438	500	20.3	119-596	ALS-596	182.80
439	630	20.3	119-561	ALS-561	240.40
440	800	119-618	ALS-618	340.70
441	1000	119-619	ALS-619	556.05

Jainson ALUMINIUM CABLE SOCKETS (CENTRAL PALM)



ITEM NO.	AREA mm ²	Jainson CAT. No.	DOWELL'S CAT. No.	PRICE EACH
442	70	JADC-25	ADC-25	19.00
443	70	JADC-33	ADC-33	34.70
444	120	JADC-26	ADC-26	40.45

CABLE TERMINAL ENDS

Jainson ALUMINIUM CRIMPING CONNECTORS



ITEM NO.	AREA mm ²	Jainson CAT. No.	DOWELL'S CAT. No.	PRICE EACH
445	2.5	119-145	ALS-145	1.35
446	2.5	119-6	ALS-6	1.35
447	4	119-5	ALS-5	1.35
448	6	119-13	ALS-13	1.35
449	10	119-146	ALS-146	1.50
450	10	119-14	ALS-14	1.70
451	16	119-4	ALS-4	2.30
452	25	119-3	ALS-3	3.15
453	35	119-2	ALS-2	4.05
454	50	119-12	ALS-12	5.95
455	70	119-1	ALS-1	10.10
456	95	119-15	ALS-15	11.20
457	120	119-9	ALS-9	15.20
458	150	119-10	ALS-10	20.60
459	185	119-11	ALS-11	26.45
460	225	119-147	ALS-147	40.10
461	240	119-16	ALS-16	44.40
462	300	119-17	ALS-17	63.45
463	400	119-18	ALS-18	91.20
464	500	119-19	ALS-19	132.70
465	625	119-20	ALS-20	177.55
466	800	119-148	ALS-148	223.60
467	1000	119-149	ALS-149	375.30

Jainson COPPER RING TONGUE TERMINAL ENDS



ITEM NO.	AREA mm ²	E Dia	Jainson CAT. No.	DOWELL'S CAT. No.	PRICE EACH
490	1.5	3.7	170489	7048	2.06
491	1.5	4.2	170499	7049	2.06
492	1.5	2.6	170009	7000	2.46
493	1.5	3.2	170019	7001	2.36
494	1.5	3.7	170029	7002	2.36
495	1.5	4.2	170039	7003	2.06
496	1.5	4.2	171549	7154	2.36
497	1.5	4.2	170049	7004	2.13
498	1.5	5.2	170059	7005	2.13
499	1.5	5.2	170069	7006	2.65
500	1.5	6.4	170079	7007	2.56
501	1.5	6.4	171069	7106	2.99
502	2.5	3.2	171079	7107	2.48
503	2.5	3.7	170089	7008	2.36
504	2.5	3.7	171089	7108	2.48
505	2.5	4.2	170099	7009	2.13
506	2.5	5.2	170109	7010	2.13
507	2.5	5.2	171099	7109	2.46
508	2.5	6.4	170119	7011	2.21
509	2.5	5.2	171109	7110	3.60
510	2.5	6.4	170129	7012	3.50
511	2.5	8.2	170139	7013	3.60
512	2.5	8.2	170149	7014	4.33
513	2.5	10.2	171519	7151	5.20
514	4.6	4.2	171559	7155	4.05
515	4.6	5.2	170509	7050	4.05
516	4.6	5.2	171579	7157	10.00
517	4.6	5.2	170169	7016	4.76
518	4.6	6.4	170179	7017	4.30
519	4.6	8.2	170189	7018	4.76
520	4.6	6.4	170199	7019	5.53
521	4.6	6.4	171159	7115	6.40
522	4.6	8.2	170209	7020	6.30
523	4.6	8.2	171169	7116	7.81
524	4.6	10.2	170239	7023	7.44
525	4.6	12.7	170249	7024	7.09
526	10	5.2	170259	7025	5.76
527	10	4.2	171199	7119	6.16
528	10	5.2	170269	7026	5.30
529	10	6.4	171209	7120	5.70
530	10	8.2	171219	7121	7.60
531	10	10.2	171239	7123	10.70
532	10	12.7	170289	7028	10.56
533	16	5.2	171249	7124	9.03
534	16	6.4	170299	7029	9.96
535	16	8.2	170309	7030	10.93
536	16	10.2	171289	7128	14.08
537	16	12.7	170339	7033	13.93
538	25	6.4	171569	7156	20.59
539	25	8.2	170349	7034	21.84

Jainson COPPER RING TONGUE TERMINAL ENDS



ITEM NO.	AREA mm ²	E Dia	Jainson CAT. No.	DOWELL'S CAT. No.	PRICE EACH
540	25	10.2	171319	7131	33.08
541	25	10.2	171329	7132	33.49
542	25	12.7	170379	7037	30.36
543	35	6.4	171339	7133	26.53
544	35	8.2	170389	7038	24.86
545	35	8.2	171349	7134	41.30
546	35	10.2	170399	7039	38.11
547	35	10.2	171359	7135	37.85
548	35	12.7	170409	7040	35.83
549	50	8.2	171369	7136	39.53
550	50	10.2	171379	7137	43.89
551	50	12.7	170429	7042	46.70
552	50	16.2	171399	7139	57.20
553	70	10.2	171409	7140	64.69
554	70	12.7	171419	7141	63.65
555	70	16.2	171429	7142	67.93
556	95	10.2	171449	7144	88.11
557	95	12.7	170449	7044	86.01
558	95	16.2	171459	7145	91.94
559	120	12.7	171469	7146	103.38
560	120	16.2	171479	7147	119.94
561	120	20.3	171489	7148	141.65
562	150	12.7	171499	7149	235.04
563	150	16.2	170459	7045	212.80
564	150	20.3	170469	7046	249.60

Jainson OPEN CLOSE TYPE SOLDERING CABLE TERMINAL ENDS



ITEM NO.	AREA mm ²	Jainson CAT. No.	DOWELL'S CAT. No.	PRICE EACH
468	1.5	153-371	OC-371	1.99
469	1.5	153-345	OC-345	1.60
470	2.5	153-372	OC-372	2.34
471	2.5	153-344	OC-344	2.11
472	4	153-373	OC-373	4.10
473	6	153-374	OC-374	5.13
474	10	153-375	OC-375	6.64
475	16	153-376	OC-376	11.41
476	25	153-377	OC-377	20.70
477	35	153-378	OC-378	26.80
478	50	153-379	OC-379	47.20
479	70	153-380	OC-380	73.50
480	95	153-381	OC-381	132.40
481	120	153-382	OC-382	169.93
482	150	153-383	OC-383	227.41
483	185	153-384	OC-384	340.00
484	225	153-385	OC-385	416.70
485	240	153-386	OC-386	504.50
486	300	153-387	OC-387	644.00
487	400	153-388	OC-388	941.01
488	500	153-389	OC-389	1105.01
489	625	153-390	OC-390	1311.68

Jainson COPPER RING TONGUE TERMINALS ENDS



(INSULATED)

ITEM NO.	AREA mm ²	E Dia	Jainson CAT. No.	DOWELL'S CAT. No.	PRICE EACH
565	1.5	2.6	170539	7053	4.34
566	1.5	3.2	170549	7054	3.36
567	1.5	3.7	170559	7055	3.36
568	1.5	4.2	170569	7056	3.14
569	1.5	3.7	170589	7058	3.14
570	1.5	4.2	170599	7059	3.14
571	1.5	4.2	170619	7061	3.38
572	1.5	5.2	170629	7062	3.38
573	1.5	4.2	170639	7063	3.44
574	1.5	5.2	170659	7065	3.76
575	1.5	6.4	170669	7066	3.61
576	1.5	6.4	170679	7067	3.96
577	2.5	3.2	170689	7068	3.39
578	2.5	3.7	170699	7069	3.39
579	2.5	3.7	170709	7070	3.71
580	2.5	4.2	170719	7071	3.36
581	2.5	5.2	170729	7072	3.36
582	2.5	5.2	170739	7073	3.84
583	2.5	6.4	170749	7074	3.66
584	2.5	5.2	170759	7075	4.88
585	2.5	6.4	170769	7076	4.80
586	0.75	4.2	175919(II)	5.25

CABLE TERMINAL ENDS

Jainson COPPER RING TONGUE TERMINAL ENDS



(INSULATED)

ITEM NO.	AREA mm ²	E DIA	Jainson CAT. No.	DOWELL'S CAT. No.	PRICE EACH
587	2.5	8.2	170779	7077	4.56
588	2.5	8.2	170799	7079	5.20
589	2.5	10.2	170819	7081	6.05
590	4-6	4.2	170839	7083	5.41
591	4-6	5.2	170849	7084	5.28
592	4-6	5.2	170869	7086	5.94
593	4-6	5.2	170879	7087	11.89
594	4-6	6.4	170899	7089	5.81
595	4-6	8.2	170909	7090	5.99
596	4-6	6.4	170929	7092	6.74
597	4-6	6.4	170939	7093	7.59
598	4-6	8.2	170949	7094	7.38
599	4-6	8.2	170969	7096	8.79
600	4-6	10.2	170999	7099	8.56
601	4-6	12.7	171009	7100	8.21

Jainson COPPER RING TONGUE TERMINAL ENDS



(INSULATED WITH METAL REINFORCEMENT)

ITEM NO.	AREA mm ²	E DIA	Jainson CAT. No.	DOWELL'S CAT. No.	PRICE EACH
602	1.5	2.6	174369	7436	5.89
603	1.5	3.2	174379	7437	4.06
604	1.5	3.7	174389	7438	4.06
605	1.5	4.2	174399	7439	4.06
606	1.5	3.7	174419	7441	4.06
607	1.5	4.2	174429	7442	4.06
608	1.5	4.2	174449	7444	4.23
609	1.5	5.2	174459	7445	4.23
610	1.5	4.2	174469	7446	4.29
611	1.5	5.2	174489	7448	4.80
612	1.5	6.4	174499	7449	4.86
613	1.5	6.4	174509	7450	5.01
614	2.5	3.2	174519	7451	4.80
615	2.5	3.7	174529	7452	4.58
616	2.5	3.7	174539	7453	4.96
617	2.5	4.2	174549	7454	4.39
618	2.5	5.2	174559	7455	4.39
619	2.5	5.2	174569	7456	4.73
620	2.5	6.4	174579	7457	4.61
621	2.5	5.2	174589	7458	6.10
622	2.5	6.4	174599	7459	6.00
623	2.5	8.2	174609	7460	6.10
624	2.5	8.2	174629	7462	5.41
625	2.5	10.2	174649	7464	7.53
626	4-6	4.2	174669	7466	7.50
627	4-6	5.2	174679	7467	6.85
628	4-6	5.2	174699	7469	7.59
629	4-6	5.2	174709	7470	14.10
630	4-6	6.4	174729	7472	7.53
631	4-6	8.2	174739	7473	7.60
632	4-6	6.4	174759	7475	8.69
633	4-6	6.4	174769	7476	9.50
634	4-6	8.2	174779	7477	9.50
635	4-6	8.2	174799	7479	10.80
636	4-6	10.2	174829	7482	10.08
637	4-6	12.7	174839	7483	10.08

Jainson COPPER RING TONGUE TERMINAL ENDS



(NON-STANDARD TYPES)

ITEM NO.	AREA mm ²	E DIA	Jainson CAT. No.	DOWELL'S CAT. No.	PRICE EACH
638	1.5	3.2	171539	7153	2.76
639	1.5	2.2	171039	7103	2.80
640	1.5	3.2	171049	7104	3.28
641	1.5	4.2	171059	7105	3.60
642	2.5	6.4	171119	7111	5.96
643	2.5	10.2	170159	7015	5.66
644	2.5	12.7	170479	7047	6.45
645	4-6	4.2	171129	7112	5.90
646	4-6	5.2	171139	7113	5.81
647	4-6	5.2	171149	7114	6.90
648	4-6	9.7	170219	7021	7.84
649	4-6	10.2	170229	7022	9.20
650	4-6	8.2	171179	7117	8.61
651	10	4.2	171189	7118	6.90
652	10	8.2	171229	7122	13.96
653	10	10.2	170279	7027	13.81
654	16	5.2	171259	7125	12.50
655	16	6.4	171269	7126	13.41
656	16	9.7	170319	7031	13.81
657	16	8.2	171279	7127	18.80
658	16	10.4	170329	7032	18.21
659	25	8.2	170519	7051	21.89
660	25	6.4	171299	7129	24.61
661	25	10.2	170359	7035	23.10
662	25	6.2	171309	7130	30.40
663	25	8.2	170369	7036	29.59
664	50	10.2	170419	7041	51.70
665	50	10.2	171389	7138	59.28
666	70	12.4	170439	7043	72.59
667	95	10.2	171439	7143	92.05
668	150	16.2	171509	7150	301.60

Jainson COPPER RING TONGUE TERMINAL ENDS



(INSULATED)

ITEM NO.	AREA mm ²	E DIA	Jainson CAT. No.	DOWELL'S CAT. No.	PRICE EACH
669	1.5	2.2	170529	7052	4.10
670	1.5	3.2	170579	7057	4.10
671	1.5	3.2	170609	7060	4.70
672	1.5	4.2	170649	7064	4.80
673	2.5	6.4	170789	7078	7.19
674	2.5	10.2	170809	7080	7.19
675	2.5	12.7	170829	7082	8.05
676	4-6	4.2	170859	7085	8.05
677	4-6	5.2	170889	7088	9.01
678	4-6	5.2	170919	7091	8.81
679	4-6	9.7	170959	7095	11.36
680	4-6	10.2	170979	7097	13.60
681	4-6	8.2	170989	7098	12.61

Jainson COPPER RING TONGUE TERMINAL ENDS



(INSULATED WITH METAL REINFORCEMENT)

ITEM NO.	AREA mm ²	E DIA	Jainson CAT. No.	DOWELL'S CAT. No.	PRICE EACH
682	1.5	2.2	174359	7435	6.00
683	1.5	3.2	174409	7440	6.00
684	1.5	3.2	174439	7443	5.28
685	1.5	4.2	174479	7447	5.68
686	2.5	6.4	174619	7461	8.33
687	2.5	10.2	174639	7463	8.33
688	2.5	12.7	174659	7465	9.33
689	4-6	4.2	174689	7468	9.83
690	4-6	5.2	174719	7471	11.01
691	4-6	5.2	174749	7474	10.98
692	4-6	9.7	174789	7478	11.78
693	4-6	10.2	174809	7480	13.56
694	4-6	8.2	174819	7481	14.76

Jainson COPPER RING TONGUE TERMINAL ENDS



(INSULATED WITH METAL REINFORCEMENT)

ITEM NO.	AREA mm ²	E DIA	Jainson CAT. No.	DOWELL'S CAT. No.	PRICE EACH
695	4	8.3	180379	8037	10.24
696	4	9.9	180389	8038	10.24
697	2.5	4.0	180399	8039	5.13
698	4	8.3	180409	8040	10.24
699	4	5.2	180419	8041	8.53
700	4	6.7	180429	8042	9.41
701	4	13.1	180439	8043	12.46
702	2.5	8.3	180449	8044	6.01
703	4	4.4	180459	8045	9.26
704	2.5	5.2	180469	8046	5.70
705	2.5	6.7	180479	8047	6.16
706	2.5	9.9	180489	8048	6.00
707	2.5	4.4	180499	8049	5.44
708	4-6	5.2	180509	8050	9.30
709	4-6	5.2	180519	8051	12.41
710	4-6	6.7	180529	8052	10.33
711	2.5	180639	8063	13.09
712	1.5	180659	8065	13.09
713	2.5	180669	8066	13.70
714	10	182439	8243	89.10
715	10	182419	8241	86.41
716	10	182429	8242	115.53
717	3	183379	8337	12.15
718	3	184059	8405	12.15
719	16	184839	8483	53.94
720	16	184849	8484	59.84
721	16	184859	8485	63.20
722	4-6	186889	8688	15.30

Jainson
 Keeping Electricity Firmly in its Place
CABLE TERMINAL ENDS

CABLE TERMINAL ENDS

Jainson COPPER RING TONGUE FORK TERMINAL ENDS



("U" CUT)

ITEM NO.	AREA mm ²	E Dia	Jainson CAT. No.	DOWELL'S CAT. No.	PRICE EACH
723	1.5	3.1	172359	7235	3.26
724	1.5	4.1	172369	7236	3.59
725	1.5	4.1	172379	7237	3.59
726	1.5	5.1	172389	7238	3.90
727	1.5	3.6	172409	7240	3.26
728	1.5	3.1	172419	7241	3.26
729	1.5	3.6	172449	7244	3.26
730	1.5	6.1	178619	7861	3.90
731	2.5	3.1	178629	7862	3.59
732	2.5	3.6	178639	7863	3.59
733	2.5	6.1	178649	7864	3.85
734	2.5	4.1	172399	7239	3.93
735	2.5	5.1	172429	7242	3.93
736	4-6	4.1	172439	7243	5.96
737	4-6	4.1	172459	7245	6.96
738	4-6	5.1	172469	7246	6.96
739	4-6	5.1	172479	7247	8.05
740	4-6	6.1	172489	7248	8.05
741	10	4.1	178659	7865	8.05
742	10	5.1	178669	7866	8.05
743	10	6.1	178679	7867	8.93
744	10	8.1	178689	7868	10.45
745	16	5.1	178699	7869	12.69
746	16	6.1	178709	7870	14.16
747	16	8.1	178719	7871	14.16
748	16	8.1	178729	7872	17.65

Jainson COPPER RING TONGUE FORK TERMINAL ENDS



("U" CUT INSULATED)

ITEM NO.	AREA mm ²	E Dia	Jainson CAT. No.	DOWELL'S CAT. No.	PRICE EACH
749	1.5	3.1	178739	7873	4.25
750	1.5	3.6	178749	7874	4.25
751	1.5	3.1	178759	7875	4.19
752	1.5	3.6	178769	7876	4.35
753	1.5	4.1	178779	7877	4.79
754	1.5	4.1	178789	7878	4.79
755	1.5	5.1	178799	7879	5.16
756	1.5	6.1	178809	7880	5.16
757	2.5	3.1	178819	7881	4.98
758	2.5	3.6	178829	7882	4.91
759	2.5	4.1	178839	7883	5.20
760	2.5	5.1	178849	7884	5.28
761	2.5	6.1	178859	7885	5.28
762	4-6	4.1	178869	7886	7.96
763	4-6	4.1	178879	7887	9.65
764	4-6	5.1	178889	7888	9.65
765	4-6	5.1	178899	7889	10.46
766	4-6	6.1	178909	7890	10.46
767	10	4.1	178919	7891	11.41
768	10	5.1	178929	7892	11.41
769	10	6.1	178939	7893	12.30
770	10	8.1	178949	7894	13.94
771	16	5.1	178959	7895	16.36
772	16	6.1	178969	7896	17.13
773	16	8.1	178979	7897	17.13
774	16	8.1	178989	7898	25.49

Jainson COPPER RING TONGUE FORK TERMINAL ENDS



("U" CUT INSULATED WITH METAL REINFORCEMENT)

ITEM NO.	AREA mm ²	E Dia	Jainson CAT. No.	DOWELL'S CAT. No.	PRICE EACH
775	1.5	3.1	178999	7899	5.68
776	1.5	3.6	179009	7900	5.68
777	1.5	3.1	179019	7901	5.68
778	1.5	3.6	179029	7902	5.68
779	1.5	4.1	179039	7903	6.40
780	1.5	4.1	179049	7904	6.40
781	1.5	5.1	179059	7905	6.40
782	1.5	6.1	179069	7906	6.93
783	2.5	3.1	179079	7907	6.93
784	2.5	3.6	179089	7908	6.93
785	2.5	4.1	179099	7909	7.04
786	2.5	5.1	179109	7910	7.04
787	2.5	6.1	179119	7911	7.04
788	4-6	4.1	179129	7912	10.40
789	4-6	4.1	179139	7913	11.84
790	4-6	5.1	179149	7914	11.84
791	4-6	5.1	179159	7915	12.90
792	4-6	6.1	179169	7916	12.90
793	10	4.1	179179	7917	15.09
794	10	5.1	179189	7918	15.09
795	10	6.1	179199	7919	15.81
796	10	8.1	179209	7920	17.90
797	16	5.1	179219	7921	21.60
798	16	6.1	179229	7922	37.81
799	16	8.1	179239	7923	38.80
800	16	8.1	179249	7924	40.64

Jainson COPPER RECTANGULAR TONGUE FORK TERMINAL ENDS



ITEM NO.	AREA mm ²	Jainson CAT. No.	DOWELL'S CAT. No.	PRICE EACH
801	1.0	FT-SPL	2.51
802	1.5	180559	8055	3.20
803	1.5	172149	7214	4.69
804	1.5	172499	7249	1.60
805	1.5	172509	7250	2.76
806	2.5	172519	7251	1.79
807	2.5	172809	7280	5.36
808	4-6	172529	7252	3.60
809	4-6	172539	7253	3.53
810	10	172549	7254	10.33
811	10	172559	7255	10.10
812	16	101319	12.65

Jainson COPPER RECTANGULAR TONGUE FORK TERMINAL ENDS



(INSULATED)

ITEM NO.	AREA mm ²	Jainson CAT. No.	DOWELL'S CAT. No.	PRICE EACH
813	1.0	FT-SPL (I)	3.39
814	1.5	179259	7925	5.59
815	1.5	179269	7926	2.39
816	1.5	179279	7927	3.71
817	2.5	179289	7928	2.79
818	2.5	179299	7929	5.96
819	4-6	179309	7930	4.90
820	4-6	179319	7931	4.80
821	10	179329	7932	12.25
822	10	179339	7933	12.10

Jainson COPPER RECTANGULAR TONGUE FORK TERMINAL ENDS



(INSULATED WITH METAL REINFORCEMENT)

ITEM NO.	AREA mm ²	Jainson CAT. No.	DOWELL'S CAT. No.	PRICE EACH
823	1.0	FT-SPL (R)	4.00
824	1.5	179349	7934	6.80
825	1.5	179359	7935	3.31
826	1.5	179369	7936	4.45
827	2.5	179379	7937	3.55
828	2.5	179389	7938	6.61
829	4-6	179399	7939	6.21
830	4-6	179409	7940	6.16
831	10	179419	7941	16.40
832	10	179429	7942	16.30

Jainson COPPER FORK HOOK TERMINAL ENDS



ITEM NO.	AREA mm ²	Jainson CAT. No.	DOWELL'S CAT. No.	PRICE EACH
833	0.75	172799	7279	4.90
834	1.5	172789	7278	4.13
835	1.5	172659	7265	4.13
836	1.5	172669	7266	4.69
837	1.5	172569	7256	4.69
838	1.5	172579	7257	5.01
839	1.5	172709	7270	5.81
840	1.5	172719	7271	5.81
841	2.5	172589	7258	5.81
842	2.5	172599	7259	5.01
843	2.5	172609	7260	6.80
844	2.5	172729	7272	6.80
845	2.5	172739	7273	5.04
846	4	172749	7274	11.13
847	4	172759	7275	11.13
848	4	172769	7276	11.13
849	4	172779	7277	11.13
850	4-6	172619	7261	9.10
851	4-6	172629	7262	9.10
852	4-6	172639	7263	9.10
853	4-6	172689	7268	7.76
854	4-6	172699	7269	7.54
855	6	172649	7264	9.10
856	6	172679	7267	9.93

Jainson COPPER FORK HOOK TERMINAL ENDS



(INSULATED)

ITEM NO.	AREA mm ²	Jainson CAT. No.	DOWELL'S CAT. No.	PRICE EACH
857	0.75	179439	7943	5.60
858	1.5	179449	7944	4.90
859	1.5	179459	7945	5.36
860	1.5	179469	7946	5.36
861	1.5	179479	7947	5.36
862	1.5	179489	7948	5.13
863	1.5	179499	7949	6.56
864	1.5	179509	7950	6.40
865	2.5	179519	7951	6.73
866	2.5	179529	7952	5.96
867	2.5	179539	7953	5.96
868	2.5	179549	7954	7.76
869	2.5	179559	7955	7.76
870	4	179569	7956	12.30
871	4-6	179609	7960	10.15
872	4-6	179639	7963	9.96
873	4-6	179649	7964	8.76

CABLE TERMINAL ENDS

Jainson FORK HOOK TERMINAL ENDS



(INSULATED WITH METAL REINFORCEMENT)

ITEM NO.	AREA mm ²	Jainson CAT. No.	DOWELL'S CAT. No.	PRICE EACH
874	0.75	179679	7967	7.30
875	1.5	179689	7968	6.76
876	1.5	179699	7969	6.76
877	1.5	179709	7970	7.25
878	1.5	179719	7971	7.25
879	1.5	179729	7972	7.25
880	1.5	179739	7973	8.33
881	1.5	179749	7974	8.33
882	2.5	179759	7975	8.80
883	2.5	179769	7976	8.13
884	2.5	179779	7977	8.13
885	2.5	179789	7978	9.93
886	2.5	179799	7979	9.93
887	4	179809	7980	15.96
888	4-6	179849	7984	13.09
889	4-6	179859	7985	13.09
890	4-6	179879	7987	11.20
891	6	179889	7988	11.20

Jainson PIN TYPE TERMINAL ENDS



ITEM NO.	AREA mm ²	Jainson CAT. No.	DOWELL'S CAT. No.	PRICE EACH
892	1.0	316-0	2.04
893	1.5	316-9	CP-9	1.79
894	1.5	316-35	CP-35	2.24
895	1.5	316-38	CP-38	5.41
896	2.5	316-1	CP-1	1.79
897	2.5	316-2	CP-2	1.85
898	4	316-3	CP-3	3.81
899	4	316-4	CP-4	7.21
900	6	316-5	CP-5	4.15
901	6	316-6	CP-6	7.41
902	10	316-7	CP-7	7.25
903	16	316-8	CP-8	9.90
904	2.5	316-10	CP-10	3.20
905	2.5	316-11	CP-11	3.20
906	4	316-12	CP-12	5.96
907	4	316-13	CP-13	6.25
908	6	316-14	CP-14	6.73
909	6	316-15	CP-15	6.73
910	10	316-16	CP-16	9.81
911	25	316-125	31.81
912	35	316-135	41.90
913	50	316-150	47.01
914	70	316-170	74.00
915	95	316-195	103.90
916	0.75	316-54	2.48

Jainson PIN TYPE TERMINAL ENDS



(INSULATED)

ITEM NO.	AREA mm ²	Jainson CAT. No.	DOWELL'S CAT. No.	PRICE EACH
917	1.0	316-0 (I)	3.19
918	1.0	316-45 (I)	CP-45	7.03
919	1.5	316-17	CP-17	2.50
920	1.5	316-40	CP-40	3.39
921	1.5	316-38 (I)	6.35
922	1.5	316-42 (I)	CP-42	7.03
923	1.5	316-51 (I)	CP-51	4.59
924	2.5	316-18	CP-18	2.69
925	2.5	316-19	CP-19	2.85
926	4	316-20	CP-20	5.48
927	4	316-21	CP-21	11.59
928	6	316-22	CP-22	11.50
929	6	316-23	CP-23	11.55
930	10	316-24	CP-24	18.55
931	16	316-25	CP-25	24.79

Jainson PIN TYPE TERMINAL ENDS



(INSULATED WITH METAL REINFORCEMENT)

ITEM NO.	AREA mm ²	Jainson CAT. No.	DOWELL'S CAT. No.	PRICE EACH
932	1.0	316-0 (R)	4.21
933	1.5	316-26	CP-26	3.44
934	2.5	316-27	CP-27	3.65
935	2.5	316-28	CP-28	3.70
936	4	316-29	CP-29	6.50
937	4	316-30	CP-30	16.00
938	6	316-31	CP-31	16.00
939	6	316-32	CP-32	16.00
940	0.75	316-54	CP-54	3.49
941	2.5	316-52	CP-52	9.50
942	10	316-33	22.00
943	16	316-34	30.70
943A	1.5	316-35 (R)	4.61

Jainson PIN TYPE, FORK TYPE RING TONGUE



ITEM NO.	AREA mm ²	TYPE	Jainson CAT. No.	PRICE EACH
944	0.75	PIN TYPE	JSP-01	2.08
945	0.75	FORK TYPE	JSF-02	1.96
946	0.75	RING TONGUE	JSR-03	2.01
947	0.75	PIN TYPE-J-14	JSP-04	2.24
948	1	PIN TYPE-J-14	JSP-05	2.40
949	1.5	PIN TYPE-J-14	JSP-06	2.61
950	1	RT 53 E3.5	JSR-07	2.50
951	1	RT 53 E4	JSR-08	2.50
952	1	RT 03 E3	JSR-09	2.56
953	1	RT 03 E4	JSR-10	2.40
954	1	RT 04 E4	JSR-11	2.64
955	1	RT 04 E5	JSR-12	2.56
956	1	RT 05 E5	JSR-13	2.80
957	1	RT 05 E6	JSR-14	2.80
958	1	RT 06 E6	JSR-15	3.01

Jainson PIN TYPE, FORK TYPE RING TONGUE



(INSULATED)

ITEM NO.	AREA mm ²	TYPE	Jainson CAT. No.	PRICE EACH
959	0.75	PIN TYPE	JSP-01 (I)	3.41
960	0.75	FORK TYPE	JSF-02 (I)	3.30
961	0.75	RING TONGUE	JSR-03 (I)	3.30
962	0.75	PIN TYPE-J-14	JSP-04 (I)	3.41
963	1	PIN TYPE-J-14	JSP-05 (I)	3.81
964	1.5	PIN TYPE-J-14	JSP-06 (I)	3.90
965	1	RT 53 E3.5	JSR-07 (I)	3.81
966	1	RT 53 E4	JSR-08 (I)	3.81
967	1	RT 03 E3	JSR-09 (I)	3.81
968	1	RT 03 E4	JSR-10 (I)	3.50
969	1	RT 04 E4	JSR-11 (I)	3.90
970	1	RT 04 E5	JSR-12 (I)	3.81
971	1	RT 05 E5	JSR-13 (I)	4.21
972	1	RT 05 E6	JSR-14 (I)	4.16
973	1	RT 06 E6	JSR-15 (I)	4.50

Jainson PIN TYPE, FORK TYPE RING TONGUE



(INSULATED WITH METAL REINFORCEMENT)

ITEM NO.	AREA mm ²	TYPE	Jainson CAT. No.	PRICE EACH
974	0.75	PIN TYPE	JSP-01 (R)	3.81
975	0.75	FORK TYPE	JSF-02 (R)	3.70
976	0.75	RING TONGUE	JSR-03 (R)	3.81
977	0.75	PIN TYPE-J-14	JSP-04 (R)	4.40
978	1	PIN TYPE-J-14	JSP-05 (R)	4.61
979	1.5	PIN TYPE-J-14	JSP-06 (R)	4.80
980	1	RT 53 E3.5	JSR-07 (R)	4.80
981	1	RT 53 E4	JSR-08 (R)	4.80
982	1	RT 03 E3	JSR-09 (R)	4.90
983	1	RT 03 E4	JSR-10 (R)	4.80
984	1	RT 04 E4	JSR-11 (R)	4.90
985	1	RT 04 E5	JSR-12 (R)	4.85
986	1	RT 05 E5	JSR-13 (R)	5.20
987	1	RT 05 E6	JSR-14 (R)	5.16
988	1	RT 06 E6	JSR-15 (R)	5.50

Jainson COPPER REDUCER TYPE TERMINAL ENDS



ITEM NO.	AREA mm ²	Jainson CAT. No.	DOWELL'S CAT. No.	PRICE EACH
989	1.5	JP-36	MP-36	19.96
990	2.5	JP-37	MP-37	18.63
991	4	JP-38	MP-38	18.63
992	6	JP-39	MP-39	19.76
993	10	JP-40	MP-40	28.08
994	10	JP-41	MP-41	38.69
995	16	JP-42	MP-42	48.68
996	25	JP-43	MP-43	54.63
997	35	JP-44	MP-44	61.88
998	50	JP-45	MP-45	87.48
999	70	JP-46	MP-46	118.35

CABLE TERMINAL ENDS

Jainson **COPPER REDUCER**
TYPE TERMINAL ENDS



ITEM NO.	AREA mm ²	Jainson CAT. No.	DOWELL'S CAT. No.	PRICE EACH
1000	2.5	RPC-1	WPC-1	14.88
1001	2.5	RPC-7	WPC-7	13.53
1002	4	RPC-15	WPC-15	14.88
1003	4	RPC-16	WPC-16	13.53
1004	6	RPC-17	WPC-17	15.84
1005	6	RPC-18	WPC-18	13.93
1006	10	RPC-19	WPC-19	18.24
1007	10	RPC-20	WPC-20	16.96
1008	10	RPC-21	WPC-21	21.20
1009	10	RPC-22	WPC-22	19.53
1010	16	RPC-23	WPC-23	36.33
1011	16	RPC-24	WPC-24	36.33
1012	16	RPC-2	WPC-2	25.60
1013	25	RPC-25	WPC-25	40.80
1014	25	RPC-3	WPC-3	55.76
1015	35	RPC-4	WPC-4	54.33
1016	50	RPC-26	WPC-26	62.08
1017	50	RPC-5	WPC-5	135.20
1018	70	RPC-27	WPC-27	99.60
1019	70	RPC-6	WPC-6	124.96
1020	70	RPC-28	WPC-28	152.88
1021	95	RPC-29	WPC-29	145.36
1022	95	RPC-8	WPC-8	203.60
1023	95	RPC-31	WPC-31	135.60
1024	95	RPC-32	WPC-32	214.64
1025	120	RPC-33	WPC-33	175.36
1026	120	RPC-34	WPC-34	174.00
1027	120	RPC-35	WPC-35	203.20
1028	120	RPC-36	WPC-36	272.00
1029	150	RPC-10	WPC-10	321.60
1030	150	RPC-37	WPC-37	249.60
1031	185	RPC-30	WPC-30	400.33
1032	185	RPC-38	WPC-38	332.80
1033	225	RPC-39	WPC-39	520.00
1034	225	RPC-46	WPC-46	651.04
1035	225	RPC-42	WPC-42	638.56
1036	240	RPC-44	WPC-44	665.60
1037	240	RPC-43	WPC-43	509.60
1038	300	RPC-45	WPC-45	640.64
1039	300	RPC-47	WPC-47	675.53

Jainson **ALUMINIUM REDUCER**
TYPE TERMINAL ENDS



ITEM NO.	AREA mm ²	Jainson CAT. No.	DOWELL'S CAT. No.	PRICE EACH
1055	2.5	RPA-1	AWP-1	7.33
1056	2.5	RPA-7	AWP-7	6.85
1057	4	RPA-15	AWP-15	7.33
1058	4	RPA-16	AWP-16	6.85
1059	6	RPA-17	AWP-17	8.33
1060	6	RPA-18	AWP-18	6.88
1061	10	RPA-19	AWP-19	9.04
1062	10	RPA-20	AWP-20	8.33
1063	10	RPA-21	AWP-21	10.16
1064	10	RPA-22	AWP-22	9.84
1065	16	RPA-23	AWP-23	19.04
1066	16	RPA-24	AWP-24	19.04
1067	16	RPA-2	AWP-2	12.73
1068	25	RPA-25	AWP-25	20.00
1069	25	RPA-3	AWP-3	26.33
1070	35	RPA-4	AWP-4	26.33
1071	50	RPA-26	AWP-26	30.33
1072	50	RPA-5	AWP-5	52.16
1073	70	RPA-27	AWP-27	45.83
1074	70	RPA-6	AWP-6	56.76
1075	70	RPA-28	AWP-28	70.19
1076	95	RPA-29	AWP-29	68.00
1077	95	RPA-8	AWP-8	91.26
1078	95	RPA-31	AWP-31	60.10
1079	95	RPA-32	AWP-32	99.13
1080	120	RPA-33	AWP-33	83.73
1081	120	RPA-34	AWP-34	83.73
1082	120	RPA-35	AWP-35	93.76
1083	120	RPA-36	AWP-36	128.80
1084	150	RPA-10	AWP-10	151.84
1085	150	RPA-37	AWP-37	121.60
1086	185	RPA-30	AWP-30	189.60
1087	185	RPA-38	AWP-38	153.60
1088	225	RPA-39	AWP-39	252.80
1089	225	RPA-46	AWP-46	358.80
1090	225	RPA-42	AWP-42	333.44
1091	240	RPA-44	AWP-44	325.93
1092	240	RPA-43	AWP-43	237.60
1093	300	RPA-45	AWP-45	304.00
1094	300	RPA-47	AWP-47	342.40

Jainson **COPPER RING TONGUE**
TERMINAL ENDS



(SPECIAL ITEMS)

ITEM NO.	AREA mm ²	Jainson CAT. No.	DOWELL'S CAT. No.	PRICE EACH
1101	7.7	171589	7158	24.80
1102	7.7	171599	7159	20.48
1103	19	171609	7160	32.24
1104	19	171619	7161	34.73
1105	45	171629	7162	126.24
1106	45	171639	7163	126.24
1107	45	171649	7164	134.16
1108	25	171769	7176	30.16
1109	50	171809	7180	69.28
1110	70	171819	7181	101.93
1111	4	171909	7190	10.35
1112	16	171939	7193	21.04
1113	10	171999	7199	13.43
1114	5-8	172059	7205	10.96
1115	5-8	172069	7206	12.69
1116	5-8	172079	7207	14.56
1117	5-8	172089	7208	27.53
1118	8-11	172099	7209	28.33
1119	11-17	172109	7210	32.24
1120	8-11	172179	7217	20.40
1121	17-23	172259	7225	26.24
1122	1.5	173219	7321	5.44
1123	2.5	173309	7330	10.73
1124	3	173349	7334	12.48
1125	4	173489	7348	13.53
1126	35	173729	7372	45.13
1127	35	173749	7374	92.96
1128	70	173799	7379	110.80
1129	150	173819	7381	472.80
1130	200	173839	7383	760.00
1131	250	173859	7385	760.00
1132	0.75	175919	7591	7.60
1133	1.0	175929	7592	8.73
1134	1.5	175939	7593	7.60
1135	1.5	175949	7594	7.60
1136	1.5	175959	7595	7.60
1137	2.5	176059	7605	10.40
1138	42	178309	7830	68.44
1139	2.5	178419	7841	14.46
1140	2.5	178429	7842	14.46
1141	3	178439	7843	15.71
1142	3	178449	7844	26.00
1143	4	178459	7845	14.46
1144	4	178469	7846	14.46
1145	3	178479	7847	15.71
1146	1.5	178489	7848	10.04
1147	4	178499	7849	16.80
1148	0.75	178509	7850	8.64
1149	4	178519	7851	15.71
1150	4	178529	7852	24.96
1151	1.5	178539	7853	12.48
1152	4	178549	7854	8.64
1153	1.5	178559	7855	8.24
1154	4	179589	7958	14.96
1155	2.5	179979	7997	8.48
1156	3	183139	8313	13.53
1157	3	183729	8372	13.53
1158	250	180539	8053	1067.04
1159	325	180549	8054	1376.96
1160	2.5	180949	8094	4.40
1161	7.7	181749	8174	22.46
1162	7.7	181759	8175	20.16
1163	45	181779	8177	130.73

Jainson **REDUCER TYPE**
SOLDERING TERMINALS



ITEM NO.	AREA Amps./ mm ²	Jainson CAT. No.	DOWELL'S CAT. No.	PRICE EACH
1040	15	JE-40	1440	18.08
1041	30	JE-41	1441	35.44
1042	60	JE-42	1442	89.53
1043	100	JE-43	1443	142.88
1044	150	JE-44	1444	220.00
1045	200	JE-45	1445	288.16
1046	300	JE-46	1446	356.96
1047	50	JE-47	1447	84.48
1048	70	JE-48	1448	114.96
1049	150	JE-49	1449	220.00
1050	50	JE-50	1450	240.00
1051	300	JE-51	1451	332.96
1052	300	JE-52	1452	400.00
1053	300	JE-53	1703	332.96
1054	400	JE-54	1704	437.60

Jainson **COPPER REDUCER TYPE**
TERMINAL ENDS



(SPECIAL ITEMS)

ITEM NO.	AREA mm ²	J Lenth	Jainson CAT. No.	PRICE EACH
1095	4	30	RPC - 51	22.24
1096	10	33	RPC - 52	29.60
1097	16	38	RPC - 53	44.16
1098	25	38	RPC - 54	59.60
1099	35	45	RPC - 55	77.44
1100	50	49	RPC - 56	83.53

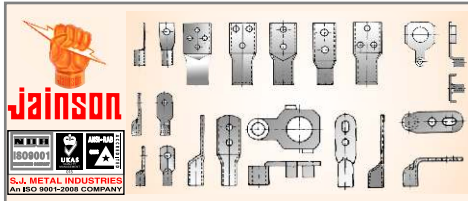

CABLE TERMINAL ENDS

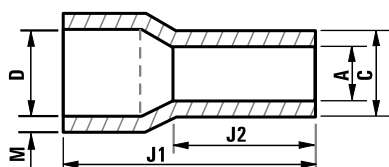

Jainson INSULATED FERRULES



ITEM No.	ACTUAL SIZE	SIZE mm ²	COLOUR	J2	A	C	D	M	J1	Jainson CAT. No.	PRICE EACH
1164		0.5	WHITE	6	1.1	1.5	2.6	0.5	12	58 - 508 L6 (I)	1.15
1165			WHITE	8	1.1	1.5	2.6	0.5	14	58 - 508 L8 (I)	1.36
1166			WHITE	10	1.1	1.5	2.6	0.5	16	58 - 508 L10 (I)	1.44
1167		0.75	BLUE	6	1.5	1.9	2.8	0.5	12	58 - 509 L6 (I)	1.36
1168			BLUE	8	1.5	1.9	2.8	0.5	14	58 - 509 L8 (I)	1.39
1169			BLUE	10	1.5	1.9	2.8	0.5	16	58 - 509 L10 (I)	1.56
1170			BLUE	12	1.5	1.9	2.8	0.5	18	58 - 509 L12 (I)	1.65
1171		1.0	RED	6	1.7	2.1	3.3	0.5	12	58 - 510 L6 (I)	1.44
1172			RED	8	1.7	2.1	3.3	0.5	14	58 - 510 L8 (I)	1.48
1173			RED	10	1.7	2.1	3.3	0.5	16	58 - 511 L10 (I)	1.56
1174			RED	12	1.7	2.1	3.3	0.5	18	58 - 511 L12 (I)	1.81
1175		1.5	BLACK	8	1.9	2.3	3.5	0.5	14	58 - 512 L8 (I)	1.48
1176			BLACK	10	1.9	2.3	3.5	0.5	16	58 - 513 L10 (I)	1.53
1177			BLACK	18	1.9	2.3	3.5	0.5	24	58 - 513 L18 (I)	2.35
1178		2.5	GREY	8	2.4	2.8	4.2	0.5	14	58 - 514 L8 (I)	1.78
1179			GREY	12	2.4	2.8	4.2	0.5	18	58 - 515 L12 (I)	2.00
1180			GREY	18	2.4	2.8	4.2	0.5	24	58 - 515 L18 (I)	2.64
1181		4	ORANGE	10	2.9	3.3	4.8	0.5	16	58 - 516 L10 (I)	2.00
1182			ORANGE	12	2.9	3.3	4.8	0.5	18	58 - 517 L12 (I)	2.33
1183			ORANGE	18	2.9	3.3	4.8	0.5	24	58 - 517 L18 (I)	3.09
1184		6	GREEN	10	3.8	4.2	6.3	0.5	18	58 - 518 L10 (I)	2.24
1185			GREEN	12	3.8	4.2	6.3	0.5	20	58 - 519 L12 (I)	2.56
1186			GREEN	15	3.8	4.2	6.3	0.5	23	58 - 520 L15 (I)	3.04
1187			GREEN	18	3.8	4.2	6.3	0.5	26	58 - 520 L18 (I)	3.28
1188		10	BROWN	12	4.7	5.1	7.6	0.7	22	58 - 521 L12 (I)	3.76
1189			BROWN	15	4.7	5.1	7.6	0.7	25	58 - 522 L15 (I)	4.08
1190			BROWN	18	4.7	5.1	7.6	0.7	28	58 - 523 L18 (I)	5.13
1191		16	WHITE	12	6.0	6.4	8.8	0.7	24	58 - 524 L12 (I)	4.80
1192			WHITE	15	6.0	6.4	8.8	0.7	27	58 - 525 L15 (I)	5.13
1193			WHITE	18	6.0	6.4	8.8	0.7	30	58 - 526 L18 (I)	5.53

CABLE TERMINAL ENDS

jainson FORK TYPE TERMINAL ENDS



ITEM NO.	AREA mm ²	E Dia	jainson CAT. No.	PRICE EACH
1194	1.5	3.7	JFT-912	2.80
1195	2.5	3.7	JFT-922	3.28
1196	4-6	5.2	JFT-940	5.44
1197	10	4.2	JFT-958	8.64
1198	1.0	4.2	JFT-908	4.64
1199	1.5	5.2	JFT-919	4.08
1200	2.5	6.4	JFT-930	6.61
1201	4-6	6.4	JFT-943	7.49
1202	10	10.2	JFT-966	8.80
1203	16	6.4	JFT-973	13.16
1204	1.5	2.2	JFT-909	4.09
1205	1.5	4.2	JFT-913	2.80
1206	1.5	2.6	JFT-914	3.80
1207	1.5	3.2	JFT-915	2.93
1208	1.5	3.7	JFT-916	2.93
1209	1.5	4.2	JFT-917	2.93
1210	1.5	5.2	JFT-918	2.93
1211	1.5	6.4	JFT-920	4.25
1212	2.5	3.2	JFT-921	3.35
1213	2.5	3.2	JFT-923	4.80
1214	2.5	3.7	JFT-924	4.80
1215	2.5	4.2	JFT-925	4.80
1216	2.5	5.2	JFT-926	4.80
1217	2.5	5.2	JFT-927	6.55
1218	2.5	6.4	JFT-928	6.55
1219	2.5	5.2	JFT-929	6.88
1220	2.5	8.2	JFT-931	6.88
1221	2.5	6.4	JFT-932	7.49
1222	2.5	8.2	JFT-933	7.49
1223	2.5	10.2	JFT-934	7.49
1224	2.5	12.7	JFT-935	7.49
1225	2.5	8.2	JFT-936	8.15
1226	2.5	10.2	JFT-937	8.15
1227	2.5	12.7	JFT-938	7.49
1228	4-6	4.2	JFT-939	5.68
1229	4-6	4.2	JFT-941	7.80
1230	4-6	5.2	JFT-942	7.80
1231	4-6	5.2	JFT-944	8.00
1232	4-6	6.4	JFT-945	8.00
1233	4-6	8.2	JFT-946	8.00
1234	4-6	6.4	JFT-947	8.19
1235	4-6	8.2	JFT-948	8.19
1236	4-6	10.2	JFT-949	8.19
1237	4-6	6.4	JFT-950	8.19
1238	4-6	8.2	JFT-951	8.60
1239	4-6	10.2	JFT-952	8.60
1240	4-6	12.7	JFT-953	8.60
1241	4-6	8.2	JFT-954	8.60
1242	4-6	10.2	JFT-955	8.60
1243	4-6	12.7	JFT-956	8.60
1244	10	4.2	JFT-957	9.28
1245	10	5.2	JFT-959	8.95
1246	10	6.4	JFT-960	8.40
1247	10	5.2	JFT-961	8.95
1248	10	6.4	JFT-962	8.40
1249	10	8.2	JFT-963	8.48

jainson FORK TYPE TERMINAL ENDS



ITEM NO.	AREA mm ²	E Dia	jainson CAT. No.	PRICE EACH
1250	10	8.2	JFT-964	9.79
1251	10	8.2	JFT-965	9.79
1252	10	10.2	JFT-967	9.60
1253	10	12.7	JFT-968	9.50
1254	16	5.2	JFT-969	13.20
1255	16	6.4	JFT-970	12.99
1256	16	8.2	JFT-971	12.99
1257	16	5.2	JFT-972	13.20
1258	16	8.2	JFT-974	13.20
1259	16	10.2	JFT-975	13.20
1260	16	6.4	JFT-976	13.60
1261	16	8.2	JFT-977	13.60
1262	16	12.7	JFT-978	13.60
1263	16	10.2	JFT-979	13.68
1264	16	12.7	JFT-980	13.68

jainson COPPER RECTANGULAR FORK TYPE TERMINAL ENDS



(INSULATED)

ITEM NO.	AREA mm ²	E Dia	jainson CAT. No.	PRICE EACH
1265	1.5	2.2	JFT-1009	3.91
1266	1.5	2.6	JFT-1010	3.91
1267	1.5	3.2	JFT-1011	3.68
1268	1.5	3.7	JFT-1012	3.68
1269	1.5	4.2	JFT-1013	3.68
1270	1.5	2.6	JFT-1014	4.15
1271	1.5	3.2	JFT-1015	4.15
1272	1.5	3.7	JFT-1016	4.15
1273	1.5	4.2	JFT-1017	4.15
1274	1.5	5.2	JFT-1018	4.15
1275	1.5	5.2	JFT-1019	4.80
1276	1.5	6.4	JFT-1020	4.80
1277	2.5	3.2	JFT-1021	4.80
1278	2.5	3.7	JFT-1022	4.80
1279	2.5	3.2	JFT-1023	5.60
1280	2.5	3.7	JFT-1024	5.60
1281	2.5	4.2	JFT-1025	5.60
1282	2.5	5.2	JFT-1026	5.75
1283	2.5	5.2	JFT-1027	5.75
1284	2.5	6.4	JFT-1028	5.75
1285	2.5	5.2	JFT-1029	6.70
1286	2.5	6.4	JFT-1030	6.80
1287	2.5	8.2	JFT-1031	7.11
1288	2.5	6.4	JFT-1032	7.11
1289	2.5	8.2	JFT-1033	7.40
1290	2.5	10.2	JFT-1034	7.40
1291	2.5	12.7	JFT-1035	7.40
1292	2.5	8.2	JFT-1036	7.40
1293	2.5	10.2	JFT-1037	7.40
1294	2.5	12.7	JFT-1038	7.40
1295	4-6	4.2	JFT-1039	5.96
1296	4-6	5.2	JFT-1040	5.96
1297	4-6	4.2	JFT-1041	7.10
1298	4-6	5.2	JFT-1042	7.10

jainson COPPER RECTANGULAR FORK TYPE TERMINAL ENDS

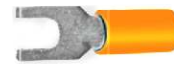

(INSULATED)

ITEM NO.	AREA mm ²	E Dia	jainson CAT. No.	PRICE EACH
1299	4-6	6.4	JFT-1043	7.10
1300	4-6	5.2	JFT-1044	7.80
1301	4-6	6.4	JFT-1045	7.80
1302	4-6	8.2	JFT-1046	7.80
1303	4-6	6.4	JFT-1047	8.60
1304	4-6	8.2	JFT-1048	8.60
1305	4-6	10.2	JFT-1049	8.60
1306	4-6	6.4	JFT-1050	9.11
1307	4-6	8.2	JFT-1051	9.11
1308	4-6	10.2	JFT-1052	9.11
1309	4-6	12.7	JFT-1053	9.11
1310	4-6	8.2	JFT-1054	9.91
1311	4-6	10.2	JFT-1055	9.91
1312	4-6	12.7	JFT-1056	9.91
1313	10	4.2	JFT-1057	11.39
1314	10	4.2	JFT-1058	11.80
1315	10	5.2	JFT-1059	11.80
1316	10	6.4	JFT-1060	11.80
1317	10	5.2	JFT-1061	11.80
1318	10	6.4	JFT-1062	11.80
1319	10	8.2	JFT-1063	11.80
1320	10	8.2	JFT-1064	12.08
1321	10	8.2	JFT-1065	12.48
1322	10	10.2	JFT-1066	12.48
1323	10	10.2	JFT-1067	12.48
1324	10	12.7	JFT-1068	12.48
1325	16	5.2	JFT-1069	14.20
1326	16	6.4	JFT-1070	14.20
1327	16	8.2	JFT-1071	14.20
1328	16	5.2	JFT-1072	14.80
1329	16	6.4	JFT-1073	14.80
1330	16	8.2	JFT-1074	14.80
1331	16	10.2	JFT-1075	14.80
1332	16	6.4	JFT-1076	15.28
1333	16	8.2	JFT-1077	15.28
1334	16	12.7	JFT-1078	15.28
1335	16	10.2	JFT-1079	15.28
1336	16	12.7	JFT-1080	15.28

jainson



CABLE TERMINAL ENDS

Jainson COPPER RECTANGULAR FORK TYPE TERMINAL ENDS



(INSULATED WITH METAL REINFORCEMENT)

ITEM NO.	AREA mm ²	E Dia	Jainson CAT. No.	PRICE EACH
1337	1.5	2.2	JFT-1109	4.89
1338	1.5	2.6	JFT-1110	4.89
1339	1.5	3.2	JFT-1111	4.80
1340	1.5	3.7	JFT-1112	5.40
1341	1.5	4.2	JFT-1113	4.89
1342	1.5	2.6	JFT-1114	6.00
1343	1.5	3.2	JFT-1115	6.00
1344	1.5	3.7	JFT-1116	6.00
1345	1.5	4.2	JFT-1117	6.00
1346	1.5	5.2	JFT-1118	6.00
1347	1.5	5.2	JFT-1119	6.70
1348	1.5	6.4	JFT-1120	6.70
1349	2.5	3.2	JFT-1121	5.00
1350	2.5	3.7	JFT-1122	5.00
1351	2.5	3.2	JFT-1123	7.20
1352	2.5	3.7	JFT-1124	7.10
1353	2.5	4.2	JFT-1125	7.10
1354	2.5	5.2	JFT-1126	8.40
1355	2.5	5.2	JFT-1127	8.40
1356	2.5	6.4	JFT-1128	8.40
1357	2.5	5.2	JFT-1129	9.20
1358	2.5	6.4	JFT-1130	9.20
1359	2.5	8.2	JFT-1131	9.20
1360	2.5	6.4	JFT-1132	10.09
1361	2.5	8.2	JFT-1133	10.09
1362	2.5	10.2	JFT-1134	10.09
1363	2.5	12.7	JFT-1135	10.09
1364	2.5	8.2	JFT-1136	11.10
1365	2.5	10.2	JFT-1137	11.10
1366	2.5	12.7	JFT-1138	11.29
1367	4.6	4.2	JFT-1139	11.29
1368	4.6	5.2	JFT-1140	11.29
1369	4.6	4.2	JFT-1141	11.29
1370	4.6	5.2	JFT-1142	11.29
1371	4.6	6.4	JFT-1143	11.29
1372	4.6	5.2	JFT-1144	12.30
1373	4.6	6.4	JFT-1145	12.30
1374	4.6	8.2	JFT-1146	12.30
1375	4.6	6.4	JFT-1147	13.10
1376	4.6	8.2	JFT-1148	13.10
1377	4.6	10.2	JFT-1149	13.10
1378	4.6	6.4	JFT-1150	14.60
1379	4.6	8.2	JFT-1151	14.60
1380	4.6	10.2	JFT-1152	14.60
1381	4.6	12.7	JFT-1153	14.60
1382	4.6	8.2	JFT-1154	15.20
1383	4.6	10.2	JFT-1155	15.20
1384	4.6	12.7	JFT-1156	15.20

Jainson COPPER RECTANGULAR FORK TYPE TERMINAL ENDS



(INSULATED WITH METAL REINFORCEMENT)

ITEM NO.	AREA mm ²	E Dia	Jainson CAT. No.	PRICE EACH
1385	10	4.2	JFT-1157	18.49
1386	10	4.2	JFT-1158	18.49
1387	10	5.2	JFT-1159	18.49
1388	10	6.4	JFT-1160	18.49
1389	10	5.2	JFT-1161	18.49
1390	10	6.4	JFT-1162	18.49
1391	10	8.2	JFT-1163	18.49
1392	10	8.2	JFT-1164	19.10
1393	10	8.2	JFT-1165	19.40
1394	10	10.2	JFT-1166	19.40
1395	10	10.2	JFT-1167	19.40
1396	10	12.7	JFT-1168	19.40
1397	16	5.2	JFT-1169	20.09
1398	16	6.4	JFT-1170	20.09
1399	16	8.2	JFT-1171	20.09
1400	16	5.2	JFT-1172	20.09
1401	16	6.4	JFT-1173	20.49
1402	16	8.2	JFT-1174	20.49
1403	16	10.2	JFT-1175	20.49
1404	16	6.4	JFT-1176	21.69
1405	16	8.2	JFT-1177	21.69
1406	16	12.7	JFT-1178	21.69
1407	16	10.2	JFT-1179	21.69
1408	16	12.7	JFT-1180	21.69

Jainson COPPER RING TONGUE TERMINAL ENDS



(INSULATED WITH METAL REINFORCEMENT)

ITEM NO.	AREA mm ²	E Dia	Jainson CAT. No.	DOWELL'S CAT. No.	PRICE EACH
1409	10	4.2	174849	7484	15.35
1410	10	5.2	174859	7485	15.35
1411	10	4.2	174869	7486	14.64
1412	10	5.2	174879	7487	14.64
1413	10	6.4	174889	7488	16.48
1414	10	8.2	174899	7489	18.01
1415	10	8.2	174909	7490	24.78
1416	10	10.2	174919	7491	24.78
1417	10	10.2	174929	7492	22.43
1418	10	12.7	174939	7493	22.43
1419	16	5.2	174949	7494	22.43
1420	16	5.2	174959	7495	23.55
1421	16	6.4	174969	7496	23.55
1422	16	6.4	174979	7497	23.55
1423	16	8.2	174989	7498	23.55
1424	16	9.7	174999	7499	23.55
1425	16	8.2	175009	7500	32.98
1426	16	10.2	175019	7501	32.98
1427	16	10.2	175029	7502	29.09
1428	16	12.7	175039	7503	29.09

Jainson COPPER RING TONGUE TERMINAL ENDS



(INSULATED)

ITEM NO.	AREA mm ²	E Dia	Jainson CAT. No.	DOWELL'S CAT. No.	PRICE EACH
1429	10	4.2	173899	7389	10.81
1430	10	5.2	173909	7390	10.81
1431	10	4.2	173919	7391	10.24
1432	10	5.2	173929	7392	10.24
1433	10	6.4	173939	7393	11.68
1434	10	8.2	173949	7394	13.30
1435	10	8.2	173959	7395	19.15
1436	10	10.2	173969	7396	19.15
1437	10	10.2	173979	7397	17.10
1438	10	12.7	173989	7398	17.10
1439	16	5.2	173999	7399	16.38
1440	16	5.2	174009	7400	18.01
1441	16	6.4	174019	7401	18.01
1442	16	6.4	174029	7402	18.01
1443	16	8.2	174039	7403	18.01
1444	16	9.7	174049	7404	18.01
1445	16	8.2	174059	7405	26.10
1446	16	10.2	174069	7406	26.10
1447	16	10.2	174079	7407	22.83
1448	16	12.7	174089	7408	22.83
1449	25	6.4	174099	7409	31.33
1450	25	8.2	174109	7410	31.33
1451	25	6.4	174119	7411	31.95
1452	25	8.2	174129	7412	31.95
1453	25	10.2	174139	7413	31.95
1454	25	6.4	174149	7414	42.59
1455	25	8.2	174159	7415	42.59
1456	25	10.2	174169	7416	46.18
1457	25	10.2	174179	7417	48.64
1458	25	12.7	174189	7418	45.86
1459	35	6.4	174199	7419	39.63
1460	35	8.2	174209	7420	39.93
1461	35	8.2	174219	7421	57.75
1462	35	10.2	174229	7422	57.75
1463	35	10.2	174239	7423	58.15
1464	35	12.7	174249	7424	58.15
1465	50	8.2	174259	7425	57.34
1466	50	10.2	174269	7426	57.34
1467	50	10.2	174279	7427	58.98
1468	50	10.2	174289	7428	67.16
1469	50	12.7	174299	7429	67.16
1470	50	16.2	174309	7430	80.48
1471	70	10.2	174319	7431	83.96
1472	70	12.7	174329	7432	86.21
1473	70	12.7	174339	7433	81.91
1474	70	16.2	174349	7434	81.91

CABLE TERMINAL ENDS

Jainson COPPER RING TONGUE SLOTTED (LOCK) HOLE TERMINAL ENDS



ITEM NO.	AREA mm ²	E Dia	Jainson CAT. No.	PRICE EACH
1475	2.5	8.2	172269	10.09
1476	4-6	11.0	172279	14.20
1477	4-6	6.6	172289	14.30
1478	10	11.0	172299	14.30
1479	10	11.0	172309	20.80
1480	16	7.5	171849	23.00
1481	16	15.0	172319	30.40
1482	25	15.0	172329	60.20
1483	25	12.7	172339	66.00
1484	25	11.0	171859	46.49
1485	35	15.0	172349	72.70
1486	70	15.0	171869	115.29

Jainson COPPER RING SLOTTED (LOCK) HOLE TYPE TERMINAL ENDS



(INSULATED)

ITEM NO.	AREA mm ²	E Dia	Jainson CAT. No.	PRICE EACH
1487	2.5	8.2	172269 (I)	13.29
1488	4-6	11.0	172279 (I)	17.60
1489	4-6	6.6	172289 (I)	17.60
1490	10	11.0	172299 (I)	20.20
1491	10	11.0	172309 (I)	22.09

Jainson COPPER RING SLOTTED (LOCK) HOLE TYPE TERMINAL ENDS



(INSULATED WITH METAL REINFORCEMENT)

ITEM NO.	AREA mm ²	E Dia	Jainson CAT. No.	PRICE EACH
1492	2.5	8.2	172269 (R)	16.30
1493	4-6	11.0	172279 (R)	20.49
1494	4-6	6.6	172289 (R)	20.49
1495	10	11.0	172299 (R)	23.00
1496	10	11.0	172309 (R)	25.29

Jainson COPPER RING TONGUE BEND TYPE



ITEM NO.	AREA mm ²	E Dia	Jainson CAT. No.	PRICE EACH
1497	1	5.0	JAB-1	6.44
1498	2.5	5.0	JAB-2.5	6.44

Jainson WEAK-BACK TYPE SOLDERING FERRULES FOR ALUMINIUM CONDUCTORS



ITEM NO.	AREA mm ²	Jainson CAT. No.	PRICE EACH
1499	6	JWB-279	13.73
1500	10	JWB-280	18.00
1501	16	JWB-281	21.20
1502	25	JWB-282	28.40
1503	35	JWB-283	41.50
1504	50	JWB-284	50.44
1505	70	JWB-285	67.60
1506	95	JWB-286	91.00
1507	120	JWB-287	110.55
1508	150	JWB-288	141.96
1509	185	JWB-289	189.80
1510	225	JWB-290	244.09
1511	240	JWB-291	278.71
1512	300	JWB-292	399.35
1513	400	JWB-293	530.30
1514	500	JWB-294	704.29
1515	625	JWB-295	957.95

Jainson SNAP ON TERMINALS



ITEM NO.	AREA mm ²	Jainson CAT. No.	DOWELL'S CAT. No.	PRICE EACH
1516	1.0	183689	8368	3.80
1517	183699	8369	3.80
1518	183709	8370	3.80
1519	1.5	183609	8360	6.04
1520	1.5	183619	8361	7.58
1521	1.5	183519	8351	4.50
1522	1.5	183519 (I)	5.75
1523	1.5	183529	8352	6.33
1524	1.5	183589	8358	3.80
1525	1.5	183599	8359	5.18
1526	1.5	183249	8324	3.53
1527	1.5	183259	8325	4.70
1528	1.5	183549	8354	3.80
1529	1.5	183559	8355	4.80
1530	1.5	181979	8197	4.29
1531	1.5	183369	8336	3.73
1532	1.5	183539	8353	5.44
1533	1.5	183569	8356	3.80
1534	1.5	183579	8357	4.80
1535	1.5	183629	8362	5.09
1536	1.5	183649	8364	3.35
1537	1.5	183679	8367	12.58
1538	1.5	186619	8661	6.24
1539	2.5	181789	8178	6.90
1540	2.5	182459	8245	5.93
1541	2.5	183319	8331	6.40
1542	2.5	183479	8347	4.78
1543	2.5	183479 (I)	6.14
1544	2.5	183489	8348	6.88
1545	2.5	183499	8349	4.78
1546	2.5	183509	8350	6.88
1547	2.5	183639	8363	5.75
1548	2.5	183659	8365	8.06
1549	2.5	183669	8366	8.06
1550	2.5	184739	8473	9.11
1551	2.5	184749	8474	11.33
1552	2.5	184759	8475	11.33
1553	2.5	184779	8477	14.88
1554	182149	8214	7.30
1555	183469	8346	8.16
1556	1.2	186939	8693	3.45
1557	1.2	186949	8694	2.69
1558	1.2	186959	8695	2.44
1559	1.2	186979	8697	1.64
1560	4	184769	8476	9.03

Jainson SNAP-ON TYPE TERMINAL



ITEM NO.	AREA mm ²	Jainson CAT. No.	PRICE EACH
1561	2.5	189609	4.80
1562	2.5	189619	5.90
1563	4	189629	12.55

Jainson SNAP ON TABS TYPE

(I) (II) (III) (IV) (V) (VI) (VII)



ITEM NO.	AREA mm ²	Jainson CAT. No.	3D CAT. No.	TYPE	PRICE EACH
1564	1.5	150849	5084	VI	6.11
1565	2.5	150859	5085	VI	6.25
1566	6	150249	5024	VI	7.33
1567	...	150449	5044	IV	4.10
1568	..	150459	5045	IV	4.61
1569	1.2	150689	5068	I	5.44
1570	1.2	150729	5072	I	5.44
1571	1.5	150659	5065	VI	5.85
1572	2.0	150669	5066	VI	5.85
1573	2.0	150739	5073	I	5.96
1574	2.0	150769	5076	I	7.61
1575	150479	5047	IV	4.76
1576	150499	5049	II	5.44
1577	150509	5050	IV	4.34
1578	150799	5079	IV	4.76
1579	150819	5081	VII	3.75
1580	2.5	151219	5121	VI	7.33
1581	6	151059	5105	VI	8.35
1582	1.2	150679	5067	I	7.30
1583	100019	III	2.65
1584	100029	V	2.65
1585	100039	VII	3.26

PRODUCT RANGE OF Jainson GROUP

- CABLE TERMINAL ENDS
- CRIMPING TOOLS
- CABLE GLANDS
- PLUG & SOCKET
- MAIN SWITCHES
- ROTARY SWITCHES
- CLIP ON TYPE TERMINALS
- BAKELITE STRIP CONNECTORS
- REVERSE FORWARD SWITCHES
- L.T. CONTROL SWITCHES
- INSTRUMENT COOLING FAN
- PRESSURE SWITCHES
- WIRE STRIPPER WITH CUTTER
- BAKELITE FUSE FITTING
- ANTI-CORROSIVE COMPOUNDS
- LIMIT SWITCHES
- CAM SWITCHES
- AIR VENT
- LOCK & KEY
- PANEL ACCESSORIES

CABLE TERMINAL ENDS

Jainson SNAP ON TABS



ITEM NO. 1586
Jainson CAT NO. 100049
PRICE EACH 4.90



ITEM NO. 1593
Jainson CAT NO. 150229
PRICE EACH 7.48

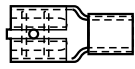

ITEM NO. 1587
Jainson CAT NO. 100059
PRICE EACH 5.30

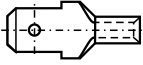

ITEM NO. 1594
Jainson CAT NO. 150349
PRICE EACH 6.40



ITEM NO. 1588
Jainson CAT NO. 100069
PRICE EACH 5.44



ITEM NO. 1595
Jainson CAT NO. 100079
PRICE EACH 7.08



ITEM NO. 1589
Jainson CAT NO. 150239
PRICE EACH 7.01

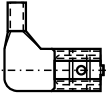

ITEM NO. 1596
Jainson CAT NO. 100089
PRICE EACH 3.30

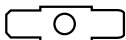

ITEM NO. 1590
Jainson CAT NO. 151019
PRICE EACH 8.64

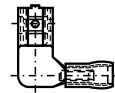

ITEM NO. 1597
Jainson CAT NO. 100099
PRICE EACH 3.14

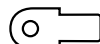

ITEM NO. 1591
Jainson CAT NO. 150619
PRICE EACH 3.25

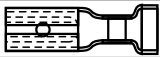

ITEM NO. 1598
Jainson CAT NO. 100109
PRICE EACH 3.65



ITEM NO. 1592
Jainson CAT NO. 150519
PRICE EACH 4.34



ITEM NO. 1599
Jainson CAT NO. 100119
PRICE EACH 4.61



Jainson BRASS SNAP-ON RING TERMINALS.



ITEM NO.	CABLE SIZE	E Dia	Jainson CAT. No.	T T CAT. No.	PRICE EACH
1600	1.0	3.2	118679	1867	2.30
1601	1.0	4.2	118479	1847	2.11
1602	1.0	4.4	118419	1841	2.79
1603	1.0	5.2	118719	1871	2.69
1604	2.5	4.4	118709	1870	2.79
1605	1.0	5.2	118229	1822	3.16
1606	2.5	5.2	118729	1872	3.75
1607	1.0	6.5	118469	1846	4.23
1608	0-2.5	6.5	118739	1873	4.51
1609	1.0	8.2	118499	1849	4.04
1610	0-3.0	6.5	118519	1851	4.61

Jainson BRASS SNAP-ON FEMALE TERMINALS WITH LANCING FOR SOCKET LOCKING



ITEM NO.	CABLE SIZE	TAB SIZE	Jainson CAT. No.	T T CAT. No.	PRICE EACH
1611	1-2.5	6.3 X 0.8	119709	1970	4.45
1612	4-6	6.3 X 0.8	110139	1013	6.53
1613	1.0	4.8 X 0.8	118649	1864	3.45

Jainson BRASS SNAP-ON FEMALE TERMINALS WITH POSITIVE DIMPLE LOCKING



ITEM NO.	CABLE SIZE	E Dia	Jainson CAT. No.	T T CAT. No.	PRICE EACH
1614	1-2.5	6.3 X 0.8	119609	1960	3.54
1615	4-6	6.3 X 0.8	110119	1011	4.90
1616	0.5-1.25	6.3 X 0.8	119619	1961	2.85
1617	0.5-2	4.8 X 0.5	119659	1965	2.18
1618	0.5-2	4.8 X 0.5	119689	1968	2.73
1619	0.5-1.0	4.8 X 0.5	118609	1860	2.73

Jainson BRASS SNAP-ON FEMALE TERMINALS WITH POSITIVE DIMPLE LOCKING



ITEM NO.	CABLE SIZE	TAB SIZE	Jainson CAT. No.	T T CAT. No.	PRICE EACH
1620	0.5-1.5	6.3 X 0.8	119679	1967	3.39
1621	2.6	6.3 X 0.8	110129	1012	4.13
1622	0.5-2	4.8 X 0.5	119759	1975	2.01
1623	0.5-2	4.8 X 0.8	119789	1978	2.40

Jainson BRASS SNAP-ON TYPE MALE TERMINAL WITH LANCING.



ITEM NO.	CABLE SIZE	TAB SIZE	Jainson CAT. No.	T T CAT. No.	PRICE EACH
1624	1.0	6.3 X 0.8	118079	1807	3.75
1625	1-2.5	6.3 X 0.8	118409	1840	4.33
1626	2.0	6.0 X 0.8	118659	1865	4.41

Jainson BRASS SNAP-ON TYPE MALE TERMINAL WITH LANCING.



ITEM NO.	CABLE SIZE	TAB SIZE	Jainson CAT. No.	T T CAT. No.	PRICE EACH
1627	1-2	6.0 X 0.8	118109	1810	3.65
1628	2.0	6.0 X 0.8	118669	1866	3.94

Jainson BRASS SNAP-ON FOLDED MALE TAB FOR SOCKET CONNECTION.



ITEM NO.	CABLE SIZE	Jainson CAT. No.	T T CAT. No.	PRICE EACH
1629	1-2	118089	1808	3.75

Jainson BRASS SNAP-ON TYPE MALE TERMINAL



ITEM NO.	CABLE SIZE	TAB SIZE	Jainson CAT. No.	T T CAT. No.	PRICE EACH
1630	1.5-2.5	6.3x0.8	119669	1966	4.41
1631	0.5-2.5	6.3x0.8	119699	1969	4.23

Jainson BRASS SNAP-ON TYPE MALE TERMINAL



ITEM NO.	CABLE SIZE	TAB SIZE	Jainson CAT. No.	T T CAT. No.	PRICE EACH
1632	0.5-1.5	4.0 Q	118259	1825	3.08
1633	0.5-1.0	4.0 Q	118549	1854	2.98

Jainson BRASS SNAP-ON TYPE BULLET FEMALE TERMINAL



ITEM NO.	CABLE SIZE	TAB SIZE	Jainson CAT. No.	T T CAT. No.	PRICE EACH
1634	1-2	4.0 Q	118099	1809	3.08

Jainson BRASS BRIGHT PRE-TINNED MALE PIN



ITEM NO.	CABLE SIZE	TAB SIZE	Jainson CAT. No.	T T CAT. No.	PRICE EACH
1635	1-2	2.0 Q	118019	1801	10.75

Jainson BRASS PRE-TINNED FEMALE TERMINALS



ITEM NO.	CABLE SIZE	TAB SIZE	Jainson CAT. No.	T T CAT. No.	PRICE EACH
1636	1-2	2.5 Q	118029	1802	9.50

CABLE TERMINAL ENDS

Jainson BRASS FEMALE PIN TERMINAL



ITEM NO.	CABLE SIZE	TAB SIZE	Jainson CAT. No.	T T CAT. No.	PRICE EACH
1637	0.5-1.5	2.0Q	118429	1842	8.93

Jainson BRASS SIDE FORK TERMINALS



ITEM NO.	CABLE SIZE	Jainson CAT. No.	T T CAT. No.	PRICE EACH
1644	1.5	118379	1837	4.33
1645	2.5	118389	1838	5.76

Jainson BRASS MID-JOINT TERMINAL (DOUBLE GRIP)



ITEM NO.	CABLE SIZE	Jainson CAT. No.	T T CAT. No.	PRICE EACH
1651	0.5-2.0	118339	1833	13.05
1652	2.0-4.0	118349	1834	16.13

Jainson BRASS PLUG IN TYPE FEMALE TERMINAL WITH NOTCHES ON ON BARREL



ITEM NO.	CABLE SIZE	TAB SIZE	Jainson CAT. No.	T T CAT. No.	PRICE EACH
1638	0.25	2.8x0.5	118069	1806	2.01

Jainson BRASS ROUND HOOK TERMINAL



ITEM NO.	CABLE SIZE	Jainson CAT. No.	T T CAT. No.	PRICE EACH
1646	1-2	118369	1836	4.90

Jainson COPPER TUBULAR TERMINAL ENDS LONG BARREL



ITEM NO.	AREA mm ²	E Dia	Jainson CAT. No.	DOWELL'S CAT. No.	PRICE EACH
1653	2.5	5.2	JEB-05	CEB/05	8.19
1654	4	6.5	JEB-06	CEB/06	11.13
1655	6	6.5	JEB-07	CEB/07	12.30
1656	10	6.5	JEB-08	CEB/08	15.33
1657	16	6.5	JEB-09	CEB/09	20.50
1658	25	6.5	JEB-10	CEB/10	34.80
1659	35	6.5	JEB-11	CEB/11	37.30
1660	35	8.2	JEB-12	CEB/12	37.30
1661	50	6.5	JEB-13	CEB/13	47.50
1662	50	8.2	JEB-14	CEB/14	47.50
1663	50	10.2	JEB-15	CEB/15	47.50
1664	70	8.2	JEB-16	CEB/16	77.60
1665	70	10.2	JEB-17	CEB/17	77.60
1666	70	12.7	JEB-18	CEB/18	77.60
1667	95	10.2	JEB-19	CEB/19	101.93
1668	95	12.7	JEB-20	CEB/20	101.93
1669	120	10.2	JEB-21	CEB/21	139.56
1670	120	12.7	JEB-22	CEB/22	139.56
1671	120	16.2	JEB-23	CEB/23	139.56
1672	150	10.2	JEB-24	CEB/24	170.25
1673	150	12.7	JEB-25	CEB/25	170.25
1674	150	16.2	JEB-26	CEB/26	170.25
1675	185	12.7	JEB-27	CEB/27	270.61
1676	185	16.2	JEB-28	CEB/28	270.61
1677	225	16.2	JEB-231	CEB/231	373.76
1678	240	16.2	JEB-29	CEB/29	379.60
1679	240	20.3	JEB-30	CEB/30	379.60
1680	300	16.2	JEB-31	CEB/31	505.76
1881	300	20.3	JEB-32	CEB/32	505.76
1682	400	20.3	JEB-33	CEB/33	747.96
1683	500	20.3	JEB-34	CEB/34	1040.00
1684	630	20.3	JEB-35	CEB/35	1456.00
1685	800	JEB-62	CEB/62	2283.84
1686	1000	JEB-76	CEB/76	4310.39

Jainson BRASS PRE-TINNED P.C.B. CONTACT TERMINAL



ITEM NO.	CABLE SIZE	Jainson CAT. No.	T T CAT. No.	PRICE EACH
1639	1-2	118039	1803	11.90

Jainson P. B. SNAP-ON FEMALE TERMINAL



ITEM NO.	CABLE SIZE	TAB SIZE	Jainson CAT. No.	T T CAT. No.	PRICE EACH
1647	1-2	2.27Q	118209	1820	9.03

Jainson BRASS SNAP ON TYPE MALE TERMINAL



ITEM NO.	CABLE SIZE	TAB SIZE	Jainson CAT. No.	T T CAT. No.	PRICE EACH
1640	0.5-1.5	2.8x0.5	118299	1829	5.28

Jainson P. B. SNAP-ON FEMALE TERMINAL



ITEM NO.	CABLE SIZE	TAB SIZE	Jainson CAT. No.	T T CAT. No.	PRICE EACH
1648	1.5-2.5	3.0	118329	1832	13.83

Jainson BRASS SNAP ON TYPE FEMALE TERMINAL



ITEM NO.	CABLE SIZE	TAB SIZE	Jainson CAT. No.	T T CAT. No.	PRICE EACH
1641	0.5-1.5	2.8x0.5	118289	1828	8.16

Jainson BRASS CENTRE SPLICE TERMINAL



ITEM NO.	CABLE SIZE	Jainson CAT. No.	T T CAT. No.	PRICE EACH
1649	1-2	118219	1821	2.40

Jainson BRASS SNAP -ON FEMALE TERMINALS



ITEM NO.	CABLE SIZE	TAB SIZE	Jainson CAT. No.	T T CAT. No.	PRICE EACH
1642	1-0	2.8x0.5	116969	1696	3.56
1643	1-0	2.8x0.8	116989	1698	4.51

Jainson BRASS CENTRE SPLICE TERMINAL (SIDE FEED)



ITEM NO.	CABLE SIZE	Jainson CAT. No.	T T CAT. No.	PRICE EACH
1650	1-2	118359	1835	7.01

★ SERIAL NO. OF PRICE LIST AND NEW CATALOGUE ARE THE SAME





**COPPER TUBULAR
TERMINAL ENDS
EXTENDED PALM
BLANKS**



ITEM NO.	AREA mm ²	Jainson CAT. No.	DOWELL'S CAT. No.	PRICE EACH
1687	50	319-466	CUS-466	96.21
1688	70	319-467	CUS-467	146.13
1689	95	319-468	CUS-468	208.63
1690	120	319-469	CUS-469	274.25
1691	150	319-470	CUS-470	358.29
1692	185	319-471	CUS-471	458.64
1693	240	319-472	CUS-472	674.75
1694	300	319-473	CUS-473	984.46
1695	400	319-474	CUS-474	1544.40
1696	500	319-475	CUS-475	2034.98
1697	625	319-476	CUS-476	2909.30



**COPPER
TUBULAR IN-LINE
CONNECTORS -
LONG BARREL.**



ITEM NO.	AREA mm ²	Jainson CAT. No.	DOWELL'S CAT. No.	PRICE EACH
1698	1.5	JBL -453	CBL -453	5.93
1699	2.5	JBL - 23	CBL - 23	7.70
1700	4.0	JBL - 3	CBL - 3	10.61
1701	6.0	JBL - 4	CBL - 4	10.73
1702	10	JBL -460	CBL -460	17.85
1703	16	JBL -6	CBL -6	16.10
1704	25	JBL - 7	CBL - 7	38.69
1705	35	JBL - 8	CBL - 8	50.70
1706	50	JBL - 9	CBL - 9	76.90
1707	70	JBL - 10	CBL - 10	113.70
1708	95	JBL - 11	CBL - 11	156.88
1709	120	JBL - 12	CBL - 12	220.10
1710	150	JBL - 13	CBL - 13	281.38
1711	185	JBL - 14	CBL - 14	341.16
1712	225	JBL - 20	CBL - 20	481.28
1713	240	JBL - 15	CBL - 15	502.24
1714	300	JBL - 16	CBL - 16	758.48
1715	400	JBL - 17	CBL - 17	1154.23
1716	500	JBL - 18	CBL - 18	1498.55
1717	630	JBL - 19	CBL - 19	2058.95
1718	800	JBL - 21	CBL - 21	3234.96
1719	1000	JBL - 22	CBL - 22	4803.99
1719A	625	32 -36	CBL -36	1708.48

- ALL DIMENSIONS ARE IN mm.
- All long barrel ring tongue are also available with insulated & metal re-inforcement at extra cost.
- Ask for Detailed technical literature.
- We also manufacture tailor made items as per customers specification



**COPPER TUBULAR
END SEALING
FERRULES**



ITEM NO.	AREA mm ²	Jainson CAT. No.	DOWELL'S CAT. No.	PRICE EACH
1720	0.5	58-467	EH-467	1.03
1721	0.75	58-468	EH-468	1.03
1722	1.0	58-469	EH-469	1.03
1723	1.0	58-470	EH-470	1.41
1724	1.5	58-471	EH-471	1.41
1725	1.5	58-472	EH-472	1.61
1726	2.5	58-499	EH-499	1.41
1727	2.5	58-502	EH-502	1.60
1728	4	58-503	EH-503	1.41
1729	4	58-504	EH-504	1.60
1730	6	58-505	EH-505	1.60
1731	6	58-506	EH-506	1.60
1732	6	58-507	EH-507	1.78
1733	10	58-549	EH-549	1.78
1734	10	58-550	EH-550	1.78
1735	10	58-551	EH-551	2.08
1736	16	58-552	EH-552	2.08
1737	16	58-553	EH-553	2.08
1738	16	58-554	EH-554	2.39



**COPPER RING
TONGUE TERMINAL**



ITEM NO.	AREA mm ²	E Dia	Jainson CAT. No.	DOWELL'S CAT. No.	PRICE EACH
1739	0.75	4.2	173179	7317	5.28
1740	1.0	4.2	173189	7318	6.44
1741	1.5	2.3	173199	7319	5.28
1742	1.5	3.0	173209	7320	5.28
1743	1.5	3.7	173229	7322	5.28
1744	1.5	3.2	173239	7323	5.28
1745	1.5	5.1	173249	7324	5.28
1746	1.5	5.0	173259	7325	5.28
1747	1.5	6.4	173269	7326	6.95
1748	1.5	8.2	173279	7327	6.95
1749	1.5	5.2	171889	7188	6.46
1750	1.5	6.4	171899	7189	7.55
1751	1.5	5.2	173289	7328	8.06
1752	2.5	3.7	173299	7329	7.50
1753	2.5	5.2	173319	7331	9.70
1754	2.5	4.2	173329	7332	9.70
1755	2.5	5.2	173339	7333	9.70
1756	3	5.2	173359	7335	12.41
1757	3	5.2	173369	7336	13.45
1758	3	6.4	173379	7337	13.45
1759	4	10.2	171919	7191	15.05
1760	4	3.2	173389	7338	10.73
1761	4	4.2	173399	7339	10.73
1762	4	5.2	173409	7340	10.73
1763	4	5.2	173419	7341	12.41



**COPPER RING
TONGUE TERMINAL**

ITEM NO.	AREA mm ²	E Dia	Jainson CAT. No.	DOWELL'S CAT. No.	PRICE EACH
1764	4	6.4	173429	7342	12.40
1765	4	6.4	173439	7343	13.43
1766	4	5.2	173449	7344	15.04
1767	4	6.4	173459	7345	15.04
1768	4	6.7	173469	7346	10.73
1769	4	6.4	173479	7348	14.98
1770	4-6	3.2	173499	7349	10.21
1771	4-6	5.2	173509	7350	13.43
1772	4-6	5.2	173519	7351	16.63
1773	4-6	6.4	173529	7352	17.70
1774	6	4.2	173539	7353	9.70
1775	6	6.4	173549	7354	13.43
1776	6	6.4	173569	7356	17.76
1777	6	8.2	173579	7357	16.63
1778	6	8.4	173589	7358	20.45
1779	6	8.2	173599	7359	16.63
1780	10	8.2	173609	7360	20.45
1781	10	8.2	172009	7200	16.64
1782	10	8.2	172159	7215	27.41
1783	10	8.4	171739	7173	52.85
1784	10	10.5	173619	7361	23.25
1785	16	6.4	171929	7192	18.84
1786	16	10.2	171949	7194	22.05
1787	10	6.4	171699	7169	27.41
1788	10	8.2	173629	7362	24.74
1789	16	10.2	173639	7363	20.45
1790	16	10.2	173649	7364	35.50
1791	16	12.7	173659	7365	25.95
1792	16	6.4	172119	7211	19.35
1793	16	8.2	172129	7212	22.05
1794	16	10.2	171759	7175	30.63
1795	16	8.2	173669	7366	42.08
1796	16	10.2	173679	7367	39.79
1797	16	10.2	173689	7368	24.18
1798	16	8.2	172169	7216	28.51
1799	16	8.4	173699	7369	58.61
1800	16	8.2	173709	7370	28.48
1801	16	10.2	173719	7371	41.94
1802	25	6.4	171779	7177	34.96
1803	25	6.4	171799	7179	37.15
1804	25	10.2	171789	7178	40.88
1805	35	8.2	171839	7183	47.35
1806	35	10.2	171829	7182	47.35
1807	35	10.2	173739	7373	93.05
1808	50	12.7	172139	7213	81.66
1809	50	10.2	173759	7375	71.54
1810	50	12.7	173769	7376	105.75
1811	50	11.0	173779	7377	92.88
1812	50	10.2	173789	7378	266.08
1813	70	12.7	171879	7187	99.43
1814	70	16.2	172019	7201	123.14
1815	95	10.2	171959	7195	129.60
1816	95	12.7	171969	7196	132.76
1817	120	10.2	173809	7380	202.13
1818	150	10.2	172029	7202	227.48
1819	150	16.2	171709	7170	428.44
1820	150	16.2	172209	7220	473.60
1821	150-192	13	173829	7382	455.33
1822	205	13	173849	7384	627.24
1823	250	20.3	173869	7386	716.80
1824	252-304	20	173879	7387	806.24

CABLE TERMINAL ENDS



Jainson **COPPER RING TONGUE TERMINAL ENDS**

(INSULATED WITH M.R.)

ITEM NO.	AREA mm ²	E Dia	Jainson CAT. No.	DOWELL'S CAT. No.	PRICE EACH
1825	1.5	3.2	180679	8067	7.76
1826	1.5	4.2	180689	8068	6.40
1827	1.5	5.2	180699	8069	7.76
1828	1.5	6.4	180709	8070	9.56
1829	1.5	8.2	180719	8071	9.56
1830	2.5	3.2	180729	8072	7.76
1831	2.5	4.4	180739	8073	7.83
1832	2.5	5.2	180749	8074	7.53
1833	2.5	6.7	180759	8075	9.10



Jainson **COPPER FORK HOOK TERMINAL ENDS**

(INSULATED)

ITEM NO.	AREA mm ²	E Dia	Jainson CAT. No.	DOWELL'S CAT. No.	PRICE EACH
1862	4	5.1	179579	7957	12.64
1863	4	8.1	179599	7959	11.88
1864	4-6	5.1	179619	7961	10.21
1865	4-6	5.1	179629	7962	10.21
1866	6	4.1	179659	7965	11.01
1867	6	4.1	179669	7966	11.45



Jainson **COPPER CRIMPING TYPE IN-LINE CONNECTORS**

ITEM NO.	AREA mm ²	Jainson CAT. No.	PRICE EACH
1900	35	JCXL - 27	53.13
1901	50	JCXL - 28	82.40
1902	70	JCXL - 29	104.80
1903	95	JCXL - 30	143.13
1904	120	JCXL - 31	208.33
1905	150	JCXL - 32	289.68
1906	185	JCXL - 33	388.51
1907	240	JCXL - 34	511.84
1908	300	JCXL - 35	752.80
1909	400	JCXL - 36	1057.44
1910	500	JCXL - 37	1379.68
1911	630	JCXL - 38	1912.00
1912	800	JCXL - 39	3192.00
1913	1000	JCXL - 40	4248.00



Jainson **COPPER RING TONGUE TERMINAL ENDS**

(INSULATED WITH M.R.)

ITEM NO.	AREA mm ²	E Dia	Jainson CAT. No.	DOWELL'S CAT. No.	PRICE EACH
1834	2.5	8.3	180769	8076	9.41
1835	2.5	9.9	180779	8077	9.99
1836	4	3.2	180789	8078	16.24
1837	4	4.4	180799	8079	15.13
1838	4	5.2	180809	8080	15.13
1839	4	6.7	180819	8081	16.51
1840	4	8.3	180829	8082	16.51
1841	4	9.9	180839	8083	16.51
1842	4	3.2	180849	8084	16.51
1843	4	4.4	180859	8085	14.53
1844	4	5.2	180869	8086	14.53
1845	4	6.7	180879	8087	16.51
1846	4	8.3	180889	8088	16.51
1847	4	9.9	180899	8089	20.33
1848	4	13.1	180909	8090	20.33



Jainson **COPPER FORK HOOK TERMINAL ENDS**

(INSULATED WITH M.R.)

ITEM NO.	AREA mm ²	E Dia	Jainson CAT. No.	DOWELL'S CAT. No.	PRICE EACH
1868	4	5.1	179819	7981	15.60
1869	4	8.1	179829	7982	15.60
1870	4	8.1	179839	7983	14.36
1871	4-6	5.1	179869	7986	12.48
1872	6	4.1	179899	7989	14.85
1873	6	4.1	179909	7990	15.08



Jainson **COPPER TUBULAR TERMINAL ENDS (LONG BARREL H. D.)**

ITEM NO.	CABLE SIZE	E Dia	Jainson CAT. No.	PRICE EACH
1874	2.5	4.2	JCXL-1	9.41
1875	4	4.2	JCXL-2	11.01
1876	6	4.2	JCXL-3	15.01
1877	10	6.4	JCXL-4	19.45
1878	16	6.4	JCXL-5	22.98
1879	25	6.4	JCXL-6	41.76
1880	35	6.4	JCXL-7	54.24
1881	50	7.8	JCXL-8	89.60
1882	70	12.8	JCXL-9	128.33
1883	95	12.8	JCXL-10	190.08
1884	120	12.8	JCXL-11	224.48
1885	150	13.0	JCXL-12	357.28
1886	185	16.2	JCXL-13	424.00
1887	240	16.2	JCXL-14	554.08
1888	300	16.2	JCXL-15	808.80
1889	400	16.2	JCXL-16	1160.64
1890	500	21.0	JCXL-17	1423.20
1891	630	21.0	JCXL-18	1907.20
1892	800	---	JCXL-19	3047.36
1893	1000	---	JCXL-20	4551.20



Jainson **ALUMINIUM IN-LINE CONNECTORS. (XLPE CABLE)**

ITEM NO.	AREA mm ²	Jainson CAT. No.	PRICE EACH
1914	25	JAXL - 1	6.20
1915	35	JAXL - 2	9.10
1916	50	JAXL - 3	14.85
1917	70	JAXL - 4	20.40
1918	95	JAXL - 5	28.35
1919	120	JAXL - 6	35.70
1920	150	JAXL - 7	47.55
1921	185	JAXL - 8	69.90
1922	225	JAXL - 9	84.45
1923	240	JAXL - 10	101.55
1924	300	JAXL - 11	129.10
1925	400	JAXL - 12	197.00
1926	500	JAXL - 13	257.30
1927	630	JAXL - 14	357.20
1928	800	JAXL - 15	488.50
1929	1000	JAXL - 16	671.55



Jainson **COPPER RING TONGUE TERMINAL ENDS**

ITEM NO.	AREA mm ²	E Dia	Jainson CAT. No.	DOWELL'S CAT. No.	PRICE EACH
1849	25	12.7	176819	7681	24.76
1850	35	12.7	176829	7682	52.10
1851	50	12.7	176839	7683	58.36
1852	70	12.7	176849	7684	69.79
1853	95	12.7	176859	7685	93.38
1854	120	12.7	176869	7686	93.38
1855	150	16.2	176879	7687	199.13
1856	185	16.2	176889	7688	333.53



Jainson **COPPER CRIMPING TYPE IN-LINE CONNECTORS**

ITEM NO.	AREA mm ²	Jainson CAT. No.	PRICE EACH
1894	2.5	JCXL - 21	5.09
1895	4	JCXL - 22	6.28
1896	6	JCXL - 23	7.53
1897	10	JCXL - 24	11.45
1898	16	JCXL - 25	21.05
1899	25	JCXL - 26	41.53



Jainson **COPPER RING TONGUE TERMINAL ENDS (60° & 90° BEND)**

ITEM NO.	AREA mm ²	E Dia	Jainson CAT. No.	DOWELL'S CAT. No.	PRICE EACH
1857	1.5	3.2	173559	7355	7.84
1858	10	6.4	173889	7388	17.38
1859	10	8.4	171739	7173	51.20
1860	10	10.5	180219	8021	62.98
1861	16	8.2	180229	8022	77.28



Jainson **ALUMINIUM LUG FOR XLPE CABLE (LONG BARREL H.D.)**

ITEM NO.	AREA mm ²	E Dia	Jainson CAT. No.	PRICE EACH
1930	25	8.2	JAXL-17	6.75
1931	35	10.2	JAXL-18	9.90
1932	50	10.2	JAXL-19	15.50
1933	70	12.7	JAXL-20	20.25
1934	95	12.7	JAXL-21	30.55
1935	120	12.7	JAXL-22	39.20
1936	150	12.7	JAXL-23	56.25
1937	185	12.7	JAXL-24	75.25
1938	225	12.7	JAXL-25	93.65
1939	240	12.7	JAXL-26	105.60
1940	300	20.3	JAXL-27	136.65
1941	400	20.3	JAXL-28	217.80
1942	500	20.3	JAXL-29	302.65
1943	625	20.3	JAXL-30	432.90
1944	800	20.3	JAXL-31	585.45
1945	1000	20.3	JAXL-32	810.70

Jainson COPPER REDUCER (SPECIAL)

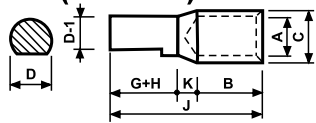

ITEM NO.	AREA mm ²	A	C	D	D1	B	K	G+H	J	Jainson CAT. No.	PRICE EACH
1946	2.5	2.5	4.7	4.7	2.7	8.0	2.0	13.0	23.0	RPC-57	13.16
1947	10	4.5	6.0	2.8	---	13.0	5.0	25.0	42.0	RPC-58	20.88
1948	25	7.0	9.0	7.5	6.5	12.0	5.0	25.0	47.0	RPC-59	55.68
1949	35	8.0	10.0	5.0	4.5	14.0	3.0	17.0	34.0	RPC-60	49.36
1950	50	9.2	11.2	7.5	6.5	18.0	3.0	20.0	41.0	RPC-61	57.70
1951	400	27.0	33.2	15.6	14.0	46.0	12.0	32.0	90.0	RPC-101	1164.93

Jainson COPPER CONNECTOR (THREE HOLE)

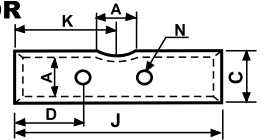

ITEM NO.	AREA mm ²	A	C	D	J	K	Jainson CAT. No.	PRICE EACH
1970	240	19.0	24.0	20.0	55.0	27.5	32-31 P1	220.18
1971	185	16.0	21.0	20.0	55.0	27.5	32-30 P2	148.06
1972	150	15.0	19.0	20.0	55.0	27.5	32-29 P3	103.76
1973	120	13.0	17.0	20.0	55.0	27.5	32-28 P4	88.58
1974	95	12.0	16.0	20.0	55.0	27.5	32-27 P5	78.46
1975	185	24.0	30.0	20.0	55.0	27.5	32-33 P6	445.43
1976	300	25.5	32.0	20.0	55.0	27.5	32-701 P7	493.50

Jainson ALUMINIUM REDUCER (SPECIAL)

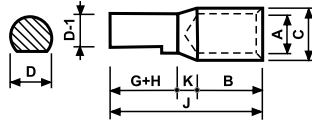

ITEM NO.	AREA mm ²	A	C	D	D1	B	K	G+H	J	Jainson CAT. No.	PRICE EACH
1952	6	3.5	5.5	3.3	3.8	7.0	4.0	18.5	29.5	RPA-51	11.65
1953	10	2.6	5.5	3.9	3.3	15.0	5.0	25.0	45.0	RPA-52	12.11
1954	25	7.0	9.0	5.0	4.5	15.0	3.0	22.5	40.5	RPA-53	16.18
1955	50	10.5	14.0	7.5	7.0	18.0	5.5	32.0	55.5	RPA-54	51.23

Jainson COPPER CONNECTOR (SINGLE HOLE)

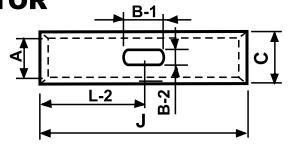

ITEM NO.	AREA mm ²	A	C	L2	B1	B2	KJ	Jainson CAT. No.	PRICE EACH
1977	240	19.0	24.0	20.0	8.0	4.0	40.0	32-55 P1	187.28
1978	185	16.0	21.0	20.0	8.0	4.0	40.0	32-54 P2	139.20
1979	150	15.0	19.0	20.0	8.0	5.0	40.0	32-53 P3	107.56
1980	120	13.0	17.0	20.0	8.0	5.0	40.0	32-52 P4	88.58
1981	95	12.0	16.0	20.0	8.0	5.0	40.0	32-51 P5	61.25
1982	185	24.0	30.0	20.0	8.0	4.0	40.0	32-57 P6	378.36
1983	300	25.5	32.0	20.0	8.0	4.0	40.0	32-702 P7	450.48

Jainson COPPER PIN TYPE

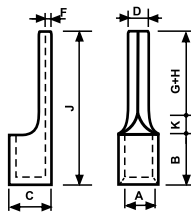

ITEM NO.	AREA mm ²	A	C	D	F	B	K	G+H	J	Jainson CAT. No.	PRICE EACH
1956	2.5	2.8	5.0	4.3	1.1	6.0	2.0	22.0	30.0	316-101	7.73
1957	2.5	2.4	4.4	4.0	1.0	4.2	1.8	24.0	30.0	316-102	9.36
1958	6	4.0	6.0	5.0	1.0	6.0	4.0	20.0	30.0	316-103	15.83
1959	6	4.0	6.0	2.7	1.0	6.0	4.0	15.0	25.0	316-104	13.16

Jainson COPPER CONNECTOR

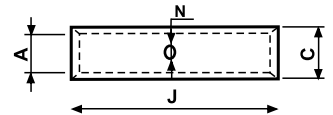

ITEM NO.	AREA mm ²	A	C	J	N	Jainson CAT. No.	PRICE EACH
1984	35	8.2	10.6	40.0	---	32-25 J40	30.36
1985	16	5.6	8.0	32.0	---	461-J32	24.00
1986	25	6.8	8.8	23.0	---	32-24-23	17.96
1987	35	8.2	10.6	25.0	---	32-25 J25	19.75
1988	150	17.5	24.5	80.0	5.0	JTC-150	501.10
1989	2.5	2.5	4.0	5.5	---	58-001	3.04
1990	2.5	2.5	4.0	7.5	---	58-002	4.05
1991	6.0	4.0	5.5	9.0	---	58-003	4.95
1992	16.0	5.4	7.1	9.0	---	58-004	5.94
1993	50.0	10.5	14.1	16.0	---	58-005	42.53

Jainson COPPER FORK TYPE TERMINALS

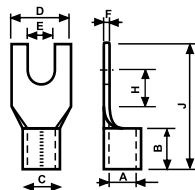

ITEM NO.	AREA mm ²	E	A	C	D	F	B	H	J	Jainson CAT. No.	PRICE EACH
1960	1.5	2.8	1.7	3.5	5.2	0.8	7.0	8.0	17.0	JFT-900	2.40
1961	1.5	4.1	1.8	3.2	8.0	0.7	5.0	8.0	18.0	185599	3.14
1962	1.5	3.5	1.8	3.2	6.5	0.7	5.0	6.8	15.0	185589	2.74
1963	2.5	4.1	2.3	3.9	8.0	0.8	5.0	8.0	18.0	185159	5.14
1964	4	4.1	3.1	5.1	8.0	1.0	6.0	8.0	19.0	185169	7.21
1965	4	5.1	3.1	5.1	10.0	1.0	6.0	8.5	20.0	185179	7.73
1966	6	5.1	3.5	5.5	10.0	1.0	6.0	8.5	20.0	185189	8.10
1967	6	6.1	3.5	5.5	14.8	1.0	6.0	10.0	22.0	185079	8.23
1968	10	6.1	4.5	6.5	14.8	1.0	8.0	10.0	24.0	185089	10.00
1969	16	6.1	5.9	8.3	14.8	1.2	10.0	10.0	26.0	185090	10.75

Jainson COPPER RING TONGUE SLOTTED (LOCK) HOLE TERMINAL ENDS

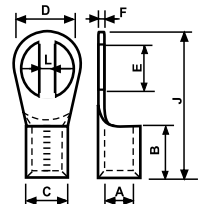

ITEM NO.	AREA mm ²	E	A	C	D	F	B	J	L	Jainson CAT. No.	PRICE EACH
1994	25	19	7.5	9.5	25.0	1.0	11.0	40.0	8.0	JRL-504A	63.28
1995	50	23	10.5	14.5	29.0	2.0	12.0	47.0	10.0	JRL-504B	113.89

CABLE TERMINAL ENDS

Jainson COPPER CONNECTOR (T TYPE)

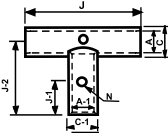

ITEM NO.	AREA mm ²	A	C	A-1	C-1	J-1	J-2	N	J	Jainson CAT. No.	PRICE EACH
1996	150	17.5	24.5	17.5	24.5	30.0	60.0	5.0	120.0	JTC-150T	1473.94

Jainson COPPER HOLLOW PIN TYPE

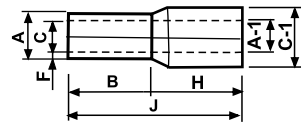

ITEM NO.	AREA mm ²	A	A-1	C	C-1	F	B	H	J	Jainson CAT. No.	PRICE EACH
2023	16	4.5	7.0	6.0	8.5	1.2	15.0	15.5	30.5	316-105	20.01

Jainson COPPER TUBULAR CRIMPING TERMINAL ENDS 45° & 90° BEND TYPE

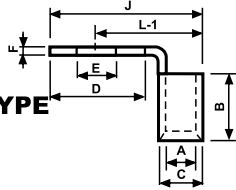

ITEM NO.	AREA mm ²	E	A	C	D	F	B	K	G+H	J	Jainson CAT. No.	PRICE EACH
1997	95	10.5	13.5	17.4	25.0	3.9	20.0	9.0	26.0	55.0	319-827	139.50
1998	95	13.5	13.5	17.4	25.0	3.9	20.0	9.0	26.0	55.0	319-828	139.50
1999	150	13.0	16.5	21.2	30.0	4.7	26.0	11.0	32.0	69.0	319-831	226.35
2000	150	17.0	16.5	21.2	30.0	4.7	26.0	11.0	32.0	69.0	319-832	226.35
2001	185	13.0	18.5	23.5	34.0	5.0	32.0	12.0	34.0	78.0	319-833	307.95
2002	185	17.0	18.5	23.5	34.0	5.0	32.0	12.0	34.0	78.0	319-833A	307.95
2003	240	17.0	21.0	26.5	38.0	5.5	38.0	14.0	40.0	92.0	319-834	452.73
2004	240	21.0	21.0	26.5	38.0	5.5	38.0	14.0	40.0	92.0	319-835	452.73
2005	300	17.0	23.5	30.0	43.0	6.5	42.0	15.0	44.0	101.0	319-836	644.85
2006	300	21.0	23.5	30.0	43.0	6.5	42.0	15.0	44.0	101.0	319-837	644.85
2007	400	17.0	26.8	34.8	50.0	8.0	44.0	18.0	52.0	114.0	319-838	1005.43

Jainson COPPER CABLE SOCKET

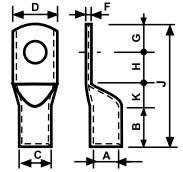

ITEM NO.	AREA mm ²	E	A	C	D	F	B	K	G+H	J	Jainson CAT. No.	PRICE EACH
2024	400	13.0	26.0	34.5	50.0	8.5	55.0	18.0	52.0	125.0	319-436	1047.55
2025	630	----	35.0	45.0	65.0	10.0	115.0	30.0	110.0	255.0	319-438	3079.49

Jainson COPPER RING TONGUE (DOUBLE HOLE)

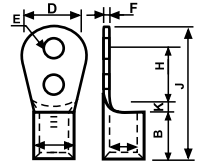

ITEM NO.	AREA mm ²	E	A	C	D	F	B	K	H	J	Jainson CAT. No.	PRICE EACH
2026	4-6	5.2	3.5	5.5	8.0	1.0	6.0	3.0	9.8	22.8	7157-DH	11.10

Jainson COPPER TUBULAR TERMINAL ENDS FOR XLPE CABLES (DOUBLE HOLE)

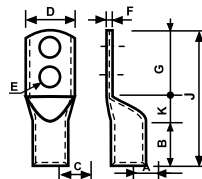

ITEM NO.	AREA mm ²	E	A	C	D	F	B	K	G	J	Jainson CAT. No.	PRICE EACH
2008	95	11.0	13.5	17.4	25.0	3.9	30.0	10.0	10.0	110.0	319-847	250.04
2009	95	13.0	13.5	17.4	25.0	3.9	30.0	10.0	10.0	110.0	319-847A	244.76
2010	120	11.0	15.0	19.4	28.0	4.4	30.0	10.0	10.0	110.0	319-848	297.15
2011	120	13.0	15.0	19.4	28.0	4.4	30.0	10.0	10.0	110.0	319-848A	291.89
2012	150	11.0	16.5	21.2	30.0	4.7	30.0	11.0	10.0	111.0	319-849	364.55
2013	150	13.0	16.5	21.2	30.0	4.7	30.0	11.0	10.0	111.0	319-849A	359.28
2014	185	13.0	18.5	23.5	34.0	5.0	43.0	12.0	10.0	114.0	319-850	427.71
2015	185	17.0	18.5	23.5	34.0	5.0	43.0	12.0	15.0	114.0	319-850A	421.13
2016	240	13.0	21.0	26.5	38.0	5.5	48.0	14.0	10.0	132.0	319-851	610.39
2017	240	17.0	21.0	26.5	38.0	5.5	48.0	14.0	15.0	132.0	319-851A	604.05
2018	300	13.0	23.5	30.0	43.0	6.5	42.0	15.0	10.0	145.0	319-852	627.75
2019	300	17.0	23.5	30.0	43.0	6.5	42.0	15.0	15.0	145.0	319-852A	883.04
2020	400	13.0	26.8	34.8	50.0	8.0	44.0	18.0	10.0	166.0	319-853	1722.40
2021	400	17.0	26.8	34.8	50.0	8.0	44.0	18.0	15.0	166.0	319-853A	1710.81
2022	400	14.0	26.8	34.8	50.0	8.0	55.0	18.0	20.0	153.0	319-437	1826.64

Jainson COPPER RING TONGUE LONG BARREL

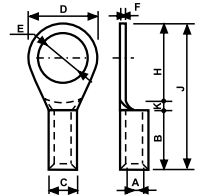

ITEM NO.	AREA mm ²	E	A	C	D	F	B	L-1	H	J	Jainson CAT. No.	PRICE EACH
2027	1.5	3.2	1.6	3.2	8.0	0.8	8.0	15.0	5.0	19.0	151932	3.28
2028	1.5	4.2	1.6	3.2	8.0	0.8	8.0	15.0	5.0	19.0	151942	3.16
2029	1.5	5.2	1.6	3.2	8.0	0.8	8.0	15.0	5.0	19.0	151952	3.16
2030	1.5	4.2	1.6	3.2	10.0	0.8	8.0	16.0	6.0	21.0	152142	4.99
2031	1.5	5.2	1.6	3.2	10.0	0.8	8.0	16.0	6.0	21.0	152152	4.86
2032	1.5	6.4	1.6	3.2	10.0	0.8	8.0	16.0	6.0	21.0	152164	4.86
2033	2.5	3.7	2.3	3.9	8.0	0.8	8.0	15.0	5.0	19.0	251937	3.95
2034	2.5	4.2	2.3	3.9	8.0	0.8	8.0	15.0	5.0	19.0	251942	3.81
2035	2.5	5.2	2.3	3.9	8.0	0.8	8.0	15.0	5.0	19.0	251952	3.81
2036	2.5	5.2	2.3	3.9	10.0	0.8	8.0	16.0	7.0	21.0	252152	3.95
2037	2.5	6.4	2.3	3.9	10.0	0.8	8.0	16.0	7.0	21.0	252164	3.81
2038	2.5	5.2	2.3	3.9	12.0	0.8	8.0	19.0	9.0	25.0	252552	5.36
2039	2.5	6.4	2.3	3.9	12.0	0.8	8.0	19.0	9.0	25.0	252564	4.99
2040	2.5	8.2	2.3	3.9	12.0	0.8	8.0	19.0	9.0	25.0	252582	4.99
2041	2.5	6.4	2.3	3.9	16.0	0.8	8.0	20.0	10.0	28.0	252864	8.16
2042	2.5	8.2	2.3	3.9	16.0	0.8	8.0	20.0	10.0	28.0	252882	7.76



Jainson
Keeping Electricity Firmly in its Place

CABLE TERMINAL ENDS



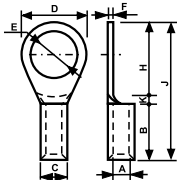



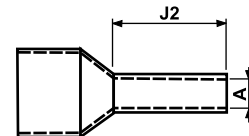
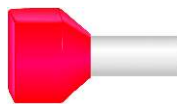

Jainson COPPER RING TONGUE LONG BARREL



ITEM NO.	AREA mm ²	E	A	C	D	F	B	L-1	H	J	Jainson CAT. No.	PRICE EACH
2043	2.5	10.2	2.3	3.9	16.0	0.8	8.0	20.0	10.0	28.0	252810	7.76
2044	2.5	10.2	2.3	3.9	18.0	0.8	8.0	23.0	14.0	32.0	253210	8.16
2045	2.5	12.7	2.3	3.9	18.0	0.8	8.0	23.0	14.0	32.0	253212	8.55
2046	2.5	3.7	2.3	3.9	6.5	0.8	7.0	11.5	3.5	17.0	251737	2.76
2047	4-6	5.2	3.5	5.5	12.0	1.0	10.0	18.0	6.0	24.0	462452	8.44
2048	4-6	6.4	3.5	5.5	12.0	1.0	10.0	18.0	6.0	24.0	462464	8.16
2049	4-6	8.2	3.5	5.5	12.0	1.0	10.0	18.0	6.0	24.0	462482	8.16
2050	4-6	5.2	3.5	5.5	8.0	1.0	10.0	22.8	9.8	26.8	462652	13.81
2051	4-6	6.4	3.5	5.5	14.0	1.0	10.0	22.5	10.5	29.5	462964	8.81
2052	4-6	8.2	3.5	5.5	14.0	1.0	10.0	22.5	10.5	29.5	462982	8.55
2053	4-6	8.2	3.5	5.5	18.0	1.0	10.0	25.0	12.0	34.0	463482	11.84
2054	4-6	10.2	3.5	5.5	18.0	1.0	10.0	25.0	12.0	34.0	463410	11.04
2055	4-6	12.7	3.5	5.5	18.0	1.0	10.0	25.0	12.0	34.0	463412	11.04
2056	10	6.4	4.3	6.3	12.0	1.0	13.0	22.0	7.0	28.0	102864	8.16
2057	10	8.2	4.3	6.3	16.0	1.0	13.0	24.0	7.0	32.0	103282	10.65
2058	10	10.2	4.3	6.3	22.0	1.0	13.0	28.0	10.0	39.0	103910	14.48
2059	10	12.7	4.3	6.3	22.0	1.0	13.0	28.0	10.0	39.0	103912	14.21
2060	16	5.2	5.6	8.0	12.0	1.2	16.0	26.0	6.0	32.0	163252	17.89
2061	16	6.4	5.6	8.0	12.0	1.2	16.0	26.0	6.0	32.0	163264	17.13
2062	16	6.4	5.6	8.0	16.0	1.2	16.0	28.0	8.0	36.0	163664	18.68
2063	16	8.2	5.6	8.0	16.0	1.2	16.0	28.0	8.0	36.0	163682	18.16
2064	16	9.7	5.6	8.0	16.0	1.2	16.0	28.0	8.0	36.0	163697	18.16
2065	16	10.2	5.6	8.0	22.0	1.2	16.0	30.0	8.0	41.0	164110	19.75
2066	16	12.7	5.6	8.0	22.0	1.2	16.0	30.0	8.0	41.0	164112	19.21
2067	25	6.4	7.5	11.1	12.0	1.8	18.0	32.0	10.0	38.0	253864	27.89
2068	25	8.2	7.5	11.1	12.0	1.8	18.0	32.0	10.0	38.0	253882	26.33
2069	25	6.4	7.5	11.1	16.0	1.8	18.0	29.0	6.0	37.0	253764	36.33
2070	25	8.2	7.5	11.1	16.0	1.8	18.0	29.0	6.0	37.0	253782	34.61
2071	25	10.2	7.5	11.1	16.0	1.8	18.0	29.0	6.0	37.0	253710	34.61
2072	25	10.2	7.5	11.1	18.0	1.8	18.0	32.0	9.0	41.0	254110	50.00
2073	25	10.2	7.5	11.1	22.0	1.8	18.0	38.0	14.0	49.0	254910	47.65
2074	25	12.7	7.5	11.1	22.0	1.8	18.0	38.0	14.0	49.0	254912	46.05
2075	35	6.4	9.0	12.6	16.0	1.8	20.0	31.0	6.0	39.0	353964	37.65
2076	35	8.2	9.0	12.6	16.0	1.8	20.0	31.0	6.0	39.0	353982	36.59
2077	35	8.2	9.0	12.6	18.0	1.8	20.0	35.0	10.0	44.0	354482	63.16
2078	35	10.2	9.0	12.6	18.0	1.8	20.0	35.0	10.0	44.0	354410	60.80
2079	35	10.2	9.0	12.6	22.0	1.8	20.0	39.0	15.0	50.0	355010	52.64
2080	35	12.7	9.0	12.6	22.0	1.8	20.0	39.0	15.0	50.0	355012	50.28
2081	35	16.2	8.0	11.6	32.0	1.8	20.0	42.0	16.0	58.0	355816	78.96
2082	35	16.2	9.0	12.6	32.0	1.8	18.0	38.0	16.0	54.0	355416	71.08
2083	50	10.2	10.5	14.1	22.0	1.8	25.0	41.0	9.0	52.0	505210	65.81
2084	50	10.2	10.5	14.1	24.0	1.8	25.0	45.0	14.0	57.0	505710	86.86
2085	50	12.7	10.5	14.1	24.0	1.8	25.0	45.0	14.0	57.0	505712	84.23
2086	50	16.2	10.5	14.0	32.0	1.8	25.0	47.0	15.0	63.0	506316	96.08
2087	50	16.2	9.5	13.1	32.0	1.8	24.0	46.0	16.0	62.0	506216	96.08
2088	70	12.7	11.5	15.5	24.0	2.0	18.0	46.0	18.0	58.0	705812	118.44
2089	70	16.2	11.5	15.1	32.0	1.8	28.0	54.0	16.0	70.0	707016	127.65
2090	95	16.2	14.0	19.0	32.0	2.3	32.0	72.0	30.0	88.0	958816	184.08
2091	150	16.2	17.5	24.7	36.0	3.6	25.0	63.0	28.0	81.0	1508116	334.28

Jainson TWIN CORD END TERMINALS



ITEM No.	ACTUAL SIZE	SIZE mm ²	J2	A	D	Jainson CAT. No.	PRICE EACH
2092	 WHITE	0.5	8.0	1.5	5.6	TW-508L8	3.50
2093	 GREY	0.75	8.0	1.8	6.2	TW-509L8	3.78
2094		0.75	10.0	1.8	6.2	TW-509L10	4.05
2095	 RED	1.0	8.0	2.0	6.0	TW-510L8	5.35
2096		1.0	10.0	2.0	6.0	TW-511L10	5.53
2097	 BLACK	1.5	8.0	2.3	7.2	TW-512L8	6.16
2098		1.5	12.0	2.3	7.2	TW-513L12	6.40
2099	 BLUE	2.5	10.0	2.9	8.5	TW-514L10	8.00
2100		2.5	12.0	2.9	8.5	TW-515L12	8.29
2101	 GREY	4.0	12.0	3.8	9.2	TW-517L12	10.69
2102	 YELLOW	6.0	14.0	4.9	10.5	TW-520L14	11.88
2103	 RED	10.0	14.0	6.5	13.0	TW-522L14	13.06
2104	 BLUE	16.0	14.0	8.3	19.3	TW-525L14	14.73

IF YOU HAVE ANY SPECIAL REQUIREMENTS OF **Jainson** BRAND CABLE LUGS, WHICH YOU ARE NOT ABLE TO LOCATE IN OUR CATALOGUE / PRICE LIST, THEN KINDLY LET US HAVE EITHER SAMPLES OR DRAWING, AS WE ALSO MANUFACTURE TAILOR MADE ITEMS.

Jainson COPPER RING TONGUE

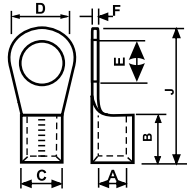

ITEM NO.	AREA mm ²	E	A	C	D	F	B	J	Jainson CAT. No.	PRICE EACH
2105	0.5	3.2	0.6	1.6	6.0	0.5	5.0	14.0	JSR-103	2.25
2106	0.5	3.7	0.6	1.6	6.0	0.5	5.0	14.0	JSR-103A	2.25
2107	0.5	3.2	0.6	1.6	8.0	0.5	5.0	16.0	JSR-104	2.50
2108	0.5	4.2	0.6	1.6	8.0	0.5	5.0	16.0	JSR-104A	2.50

Jainson COPPER RING TONGUE (INSULATED)

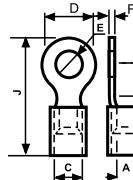

ITEM NO.	AREA mm ²	E	A	C	D	F	B	J	Jainson CAT. No.	PRICE EACH
2109	0.5	3.2	0.6	1.6	6.0	0.5	5.0	17.0	JSR-103(I)	3.38
2110	0.5	3.7	0.6	1.6	6.0	0.5	5.0	17.10	JSR-103A(I)	3.38
2111	0.5	3.2	0.6	1.6	8.0	0.5	5.0	19.00	JSR-104(I)	3.75
2112	0.5	4.2	0.6	1.6	8.0	0.5	5.0	19.00	JSR-104A(I)	3.75

Jainson COPPER PIN TYPE (INSULATED)

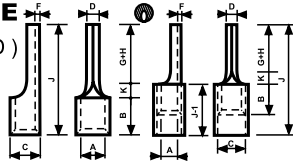

ITEM NO.	AREA mm ²	A	C	D	F	B	G+H	K	J	Jainson CAT. No.	PRICE EACH
2113	0.5	0.6	1.6	1.5	0.5	5.0	10.0	2.0	17.0	JSP-02	2.44
2114	0.5	0.6	1.6	1.5	0.5	5.0	10.0	2.0	20.0	JSP-02(I)	3.50

Jainson COPPER RECTANGULAR TONGUE FORK TERMINAL ENDS (INSULATED)

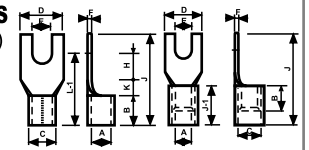

ITEM NO.	AREA mm ²	E	A	C	D	F	B	J	Jainson CAT. No.	PRICE EACH
2115	0.5	3.1	0.6	1.6	7.0	0.5	5.0	13.0	JSF-102	2.25
2116	0.5	3.1	0.6	1.6	7.0	0.5	5.0	16.0	JSF-102(I)	3.38

Jainson COPPER TUBULAR CRIMPING TERMINAL ENDS (XLPE)

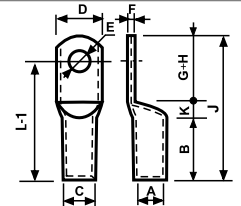

ITEM NO.	AREA mm ²	E	A	C	D	B	K	G+H	J	L-1	Jainson CAT. No.	PRICE EACH
2117	70	17.0	11.2	14.7	28.0	21.0	7.0	32.0	60.0	44.0	319-559SP	127.50

Jainson SNAP ON TABS



TYPE I



TYPE II

ITEM NO.	TAB SIZE	TYPE	F	Jainson CAT. No.	PRICE EACH
2118	6.3	I	0.8	T- TOP	6.50
2119	----	II	0.25	C-CLIP	1.56

PRICES ARE EXCLUSIVE OF ALL TAXES & DUTIES.

ALL PRICES ARE SUBJECT TO CHANGE WITHOUT PRIOR NOTICE.



Keeping electricity firmly in it's place

